



Contents

Cable Trunking System
pg15- pg19

Cable Trunking Product Intro	15
Cable Trunking Straight	17
Cable Trunking Accessories	19

Perforated Cable Tray System
pg23- pg39

Perforated Cable Tray Product Intro	23
Cable Tray "Type U" Straight	25
Cable Tray Accessories "Type U"	27
Cable Tray "Type C - 90D" Straight	29
Cable Tray Accessories "Type C - 90D"	31
Cable Tray "Type C - 45D" Straight	33
Cable Tray Accessories "Type C - 45D"	35
Cable Tray "Type T" Straight	37
Cable Tray Accessories "Type T"	39

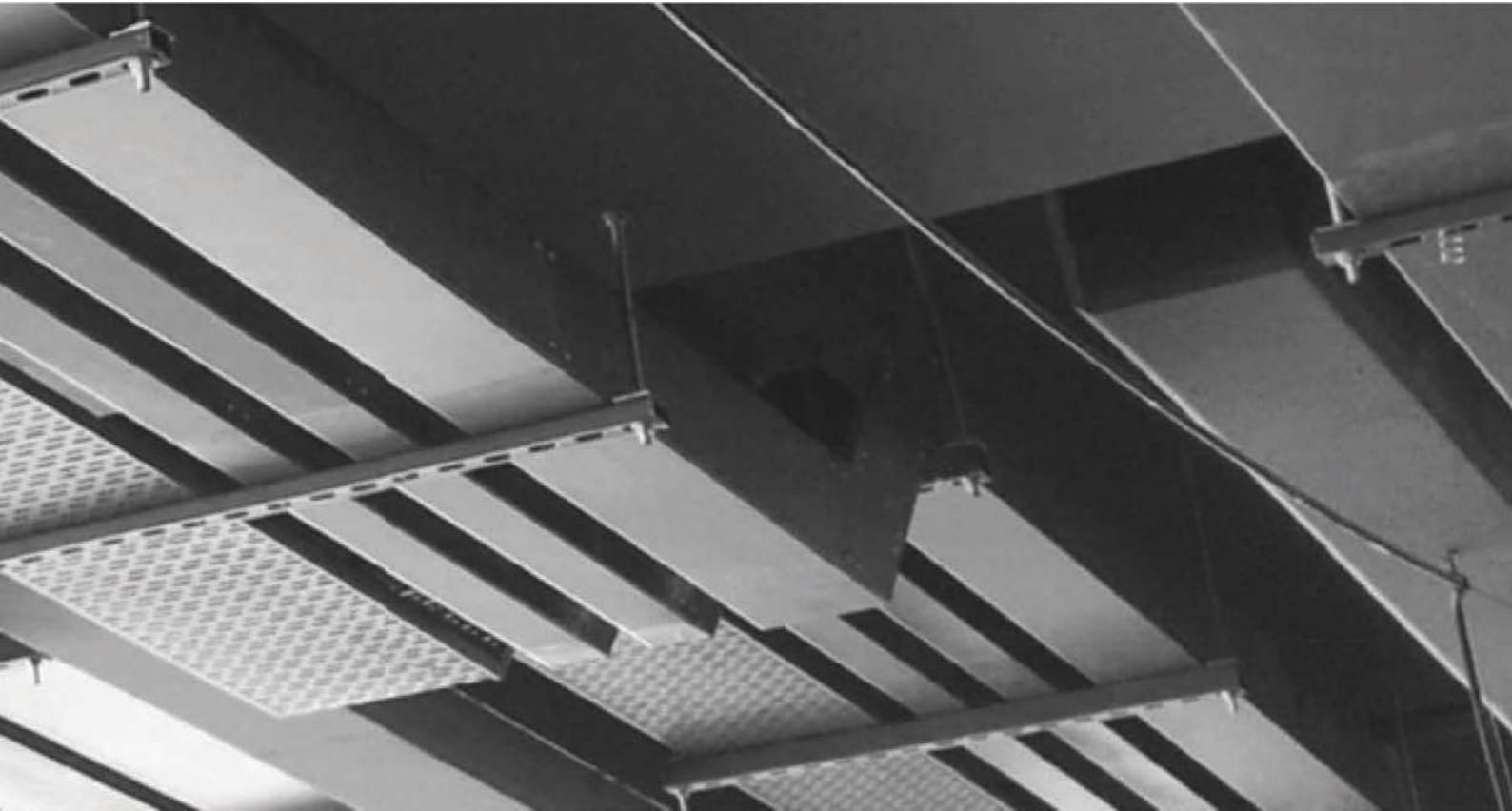

Cable Ladder System pg41 - pg61

Cable Ladder Product Intro	41
Cable Ladder "Type Z" Straight	43
Cable Ladder Accessories "Type Z"	45
Cable Ladder "Type G - Inner" Straight	47
Cable Ladder Accessories "Type G - Inner"	49
Cable Ladder "Type G - Outer" Straight	51
Cable Ladder Accessories "Type G - Outer"	53
Cable Ladder "Type C - Inner" Straight	55
Cable Ladder Accessories "Type C - Inner"	57
Cable Ladder "Type C - Outer" Straight	59
Cable Ladder Accessories "Type C - Outer"	61

Ordering References

pg63

Ordering References	63
---------------------	----

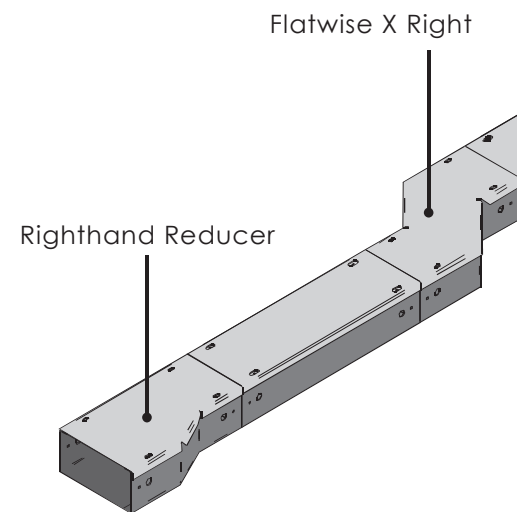

Cable Trunking System

Cable trunking is an enclosure usually with a rectangular cross section, and with one removable or hinged side, that is used to protect cables and provide space for other electrical equipment. They make electrical ducting and cable trunking for concealing and securing cabling.

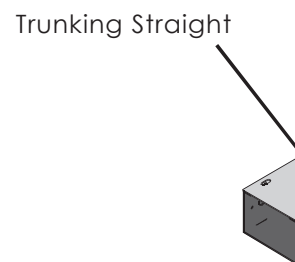

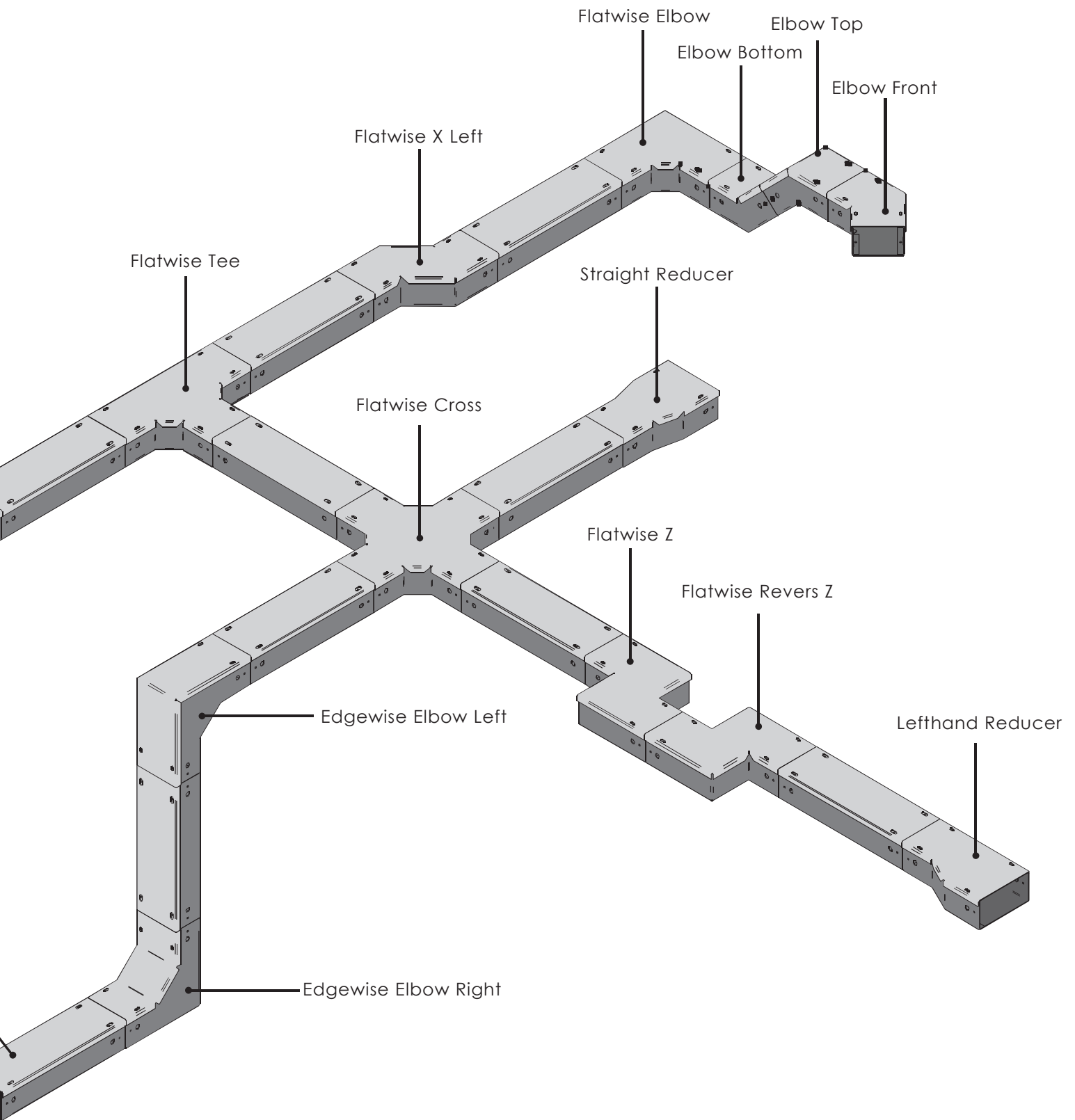

Screw Fix Type

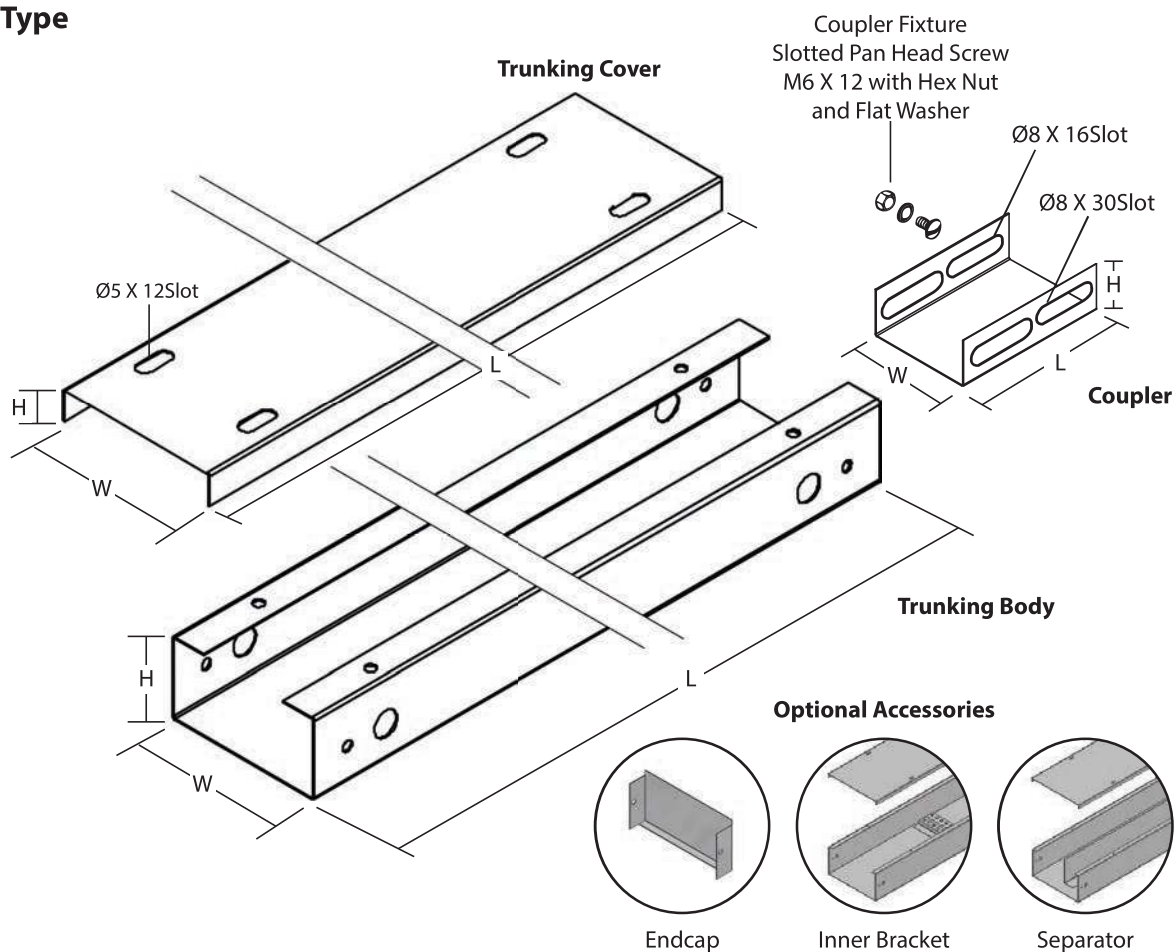

Screw Fix Type

Model	Size (mm)		Thickness (mm)		Size (mm)	
	Cover (LxWxH)	Body (LxWxH)	Cover	Body	Coupler (LxWxH)	Thickness
STK 1/2	2438 / 3000 x 54 x 10	2438 / 3000 x 50 x 25	1.0	1.0	80 x 46 x 21	1.0
STK 2/2	2438 / 3000 x 54 x 10	2438 / 3000 x 50 x 50	1.0	1.0	80 x 46 x 40	1.0
STK 2/3	2438 / 3000 x 79 x 10	2438 / 3000 x 75 x 50	1.2	1.2	80 x 70 x 40	1.2
STK 2/4	2438 / 3000 x 104 x 10	2438 / 3000 x 100 x 50	1.2	1.2	80 x 96 x 40	1.2
STK 2/6	2438 / 3000 x 155 x 10	2438 / 3000 x 150 x 50	1.4	1.6	80 x 144 x 40	1.6
STK 2/8	2438 / 3000 x 205 x 10	2438 / 3000 x 200 x 50	1.4	1.6	80 x 194 x 40	1.6
STK 2/10	2438 / 3000 x 255 x 10	2438 / 3000 x 250 x 50	1.4	1.6	80 x 244 x 40	1.6
STK 2/12	2438 / 3000 x 305 x 10	2438 / 3000 x 300 x 50	1.4	1.6	80 x 294 x 40	1.6
STK 2/14	2438 / 3000 x 355 x 10	2438 / 3000 x 350 x 50	1.4	1.6	80 x 344 x 40	1.6
STK 3/3	2438 / 3000 x 79 x 10	2438 / 3000 x 75 x 75	1.2	1.2	80 x 72 x 65	1.2
STK 3/4	2438 / 3000 x 104 x 10	2438 / 3000 x 100 x 75	1.2	1.2	80 x 96 x 65	1.2
STK 3/6	2438 / 3000 x 155 x 10	2438 / 3000 x 150 x 75	1.4	1.6	80 x 144 x 65	1.6
STK 3/8	2438 / 3000 x 205 x 10	2438 / 3000 x 200 x 75	1.4	1.6	80 x 194 x 65	1.6
STK 3/10	2438 / 3000 x 255 x 10	2438 / 3000 x 250 x 75	1.4	1.6	80 x 244 x 65	1.6
STK 3/12	2438 / 3000 x 305 x 10	2438 / 3000 x 300 x 75	1.4	1.6	80 x 294 x 65	1.6
STK 4/4	2438 / 3000 x 104 x 10	2438 / 3000 x 100 x 100	1.4	1.6	80 x 90 x 90	1.6
STK 4/6	2438 / 3000 x 155 x 10	2438 / 3000 x 150 x 100	1.4	1.6	80 x 144 x 90	1.6
STK 4/8	2438 / 3000 x 205 x 10	2438 / 3000 x 200 x 100	1.4	1.6	80 x 194 x 90	1.6
STK 4/10	2438 / 3000 x 255 x 10	2438 / 3000 x 250 x 100	1.4	1.6	80 x 244 x 90	1.6
STK 4/12	2438 / 3000 x 305 x 10	2438 / 3000 x 300 x 100	1.4	1.6	80 x 294 x 90	1.6
STK 6/6	2438 / 3000 x 155 x 10	2438 / 3000 x 150 x 150	1.4	1.6	80 x 144 x 120	1.6
STK 6/8	2438 / 3000 x 205 x 10	2438 / 3000 x 200 x 150	1.4	1.6	80 x 194 x 120	1.6

**Specification subject to change without prior notice.

***Thickness Tolerance with + - 10%

*For order information, please refer page 63.

Cable Trunking System

Cable Trunking Straight



Turnbuckle Type

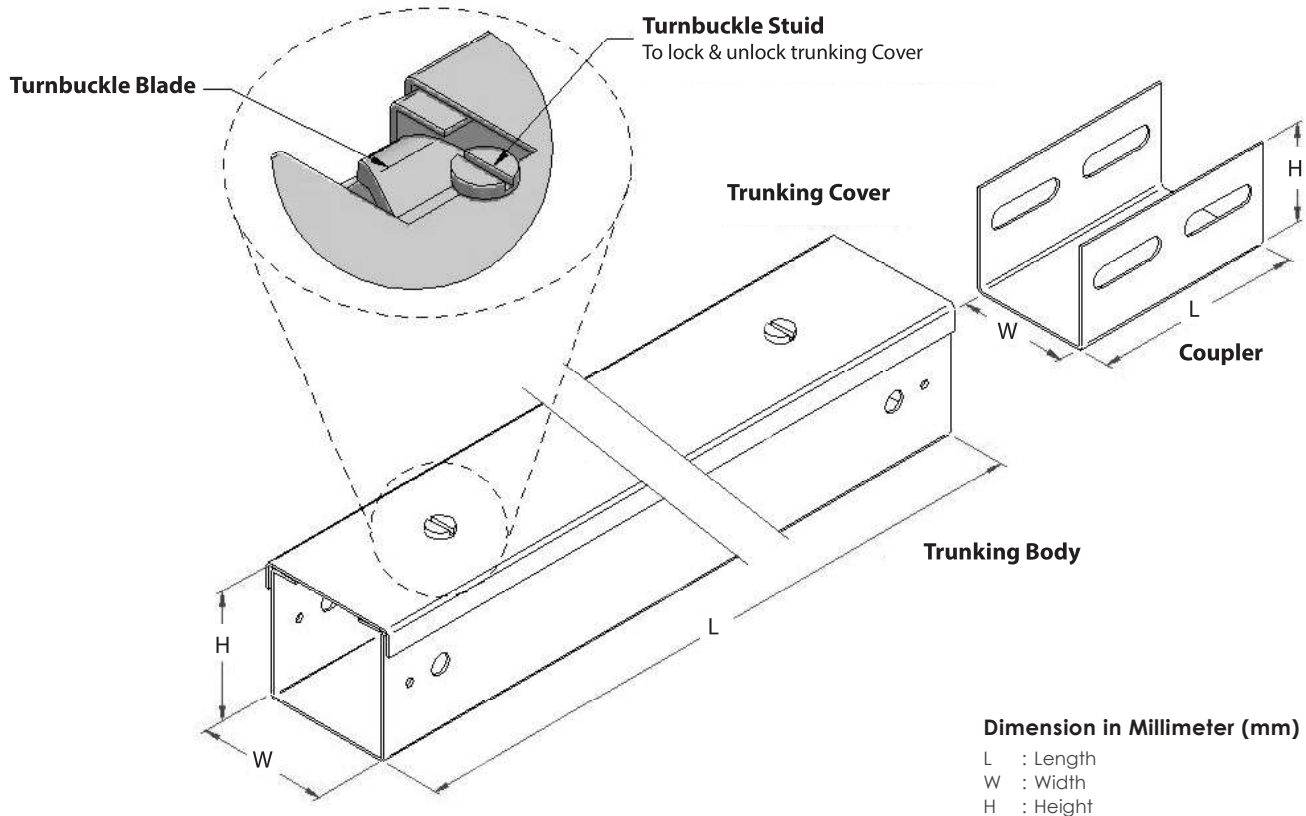

Dimension in Millimeter (mm)

L : Length

W : Width

H : Height

Turnbuckle Type

Model	Size (mm)		Thickness (mm)		Size (mm)	
	Cover (LxWxH)	Body (LxWxH)	Cover	Body	Coupler (LxWxH)	Thickness
STK 1/2-TB	2438 / 3000 x 54 x 10	2438 / 3000 x 50 x 25	1.0	1.0	80 x 46 x 21	1.0
STK 2/2-TB	2438 / 3000 x 54 x 10	2438 / 3000 x 50 x 50	1.0	1.0	80 x 46 x 40	1.0
STK 2/3-TB	2438 / 3000 x 79 x 10	2438 / 3000 x 75 x 50	1.2	1.2	80 x 72 x 40	1.2
STK 2/4-TB	2438 / 3000 x 104 x 10	2438 / 3000 x 100 x 50	1.2	1.2	80 x 96 x 40	1.2
STK 2/6-TB	2438 / 3000 x 155 x 10	2438 / 3000 x 150 x 50	1.4	1.6	80 x 144 x 40	1.6
STK 2/8-TB	2438 / 3000 x 205 x 10	2438 / 3000 x 200 x 50	1.4	1.6	80 x 194 x 40	1.6
STK 2/10-TB	2438 / 3000 x 255 x 10	2438 / 3000 x 250 x 50	1.4	1.6	80 x 244 x 40	1.6
STK 2/12-TB	2438 / 3000 x 305 x 10	2438 / 3000 x 300 x 50	1.4	1.6	80 x 294 x 40	1.6
STK 2/14-TB	2438 / 3000 x 355 x 10	2438 / 3000 x 350 x 50	1.4	1.6	80 x 344 x 40	1.6
STK 3/3-TB	2438 / 3000 x 79 x 10	2438 / 3000 x 75 x 75	1.2	1.2	80 x 72 x 65	1.2
STK 3/4-TB	2438 / 3000 x 104 x 10	2438 / 3000 x 100 x 75	1.2	1.2	80 x 96 x 65	1.2
STK 3/6-TB	2438 / 3000 x 155 x 10	2438 / 3000 x 150 x 75	1.4	1.6	80 x 144 x 65	1.6
STK 3/8-TB	2438 / 3000 x 205 x 10	2438 / 3000 x 200 x 75	1.4	1.6	80 x 194 x 65	1.6
STK 3/10-TB	2438 / 3000 x 255 x 10	2438 / 3000 x 250 x 75	1.4	1.6	80 x 244 x 65	1.6
STK 3/12-TB	2438 / 3000 x 305 x 10	2438 / 3000 x 300 x 75	1.4	1.6	80 x 294 x 90	1.6
STK 4/4-TB	2438 / 3000 x 104 x 10	2438 / 3000 x 100 x 100	1.4	1.6	80 x 96 x 90	1.6
STK 4/6-TB	2438 / 3000 x 155 x 10	2438 / 3000 x 150 x 100	1.4	1.6	80 x 144 x 90	1.6
STK 4/8-TB	2438 / 3000 x 205 x 10	2438 / 3000 x 200 x 100	1.4	1.6	80 x 194 x 90	1.6
STK 4/10-TB	2438 / 3000 x 255 x 10	2438 / 3000 x 250 x 100	1.4	1.6	80 x 244 x 90	1.6
STK 4/12-TB	2438 / 3000 x 305 x 10	2438 / 3000 x 300 x 100	1.4	1.6	80 x 294 x 90	1.6
STK 6/6-TB	2438 / 3000 x 155 x 10	2438 / 3000 x 150 x 150	1.4	1.6	80 x 144 x 120	1.6
STK 6/8-TB	2438 / 3000 x 205 x 10	2438 / 3000 x 200 x 150	1.4	1.6	80 x 194 x 120	1.6

**Specification subject to change without prior notice.

*For order information, please refer page 63.

***Thickness Tolerance with + - 10%

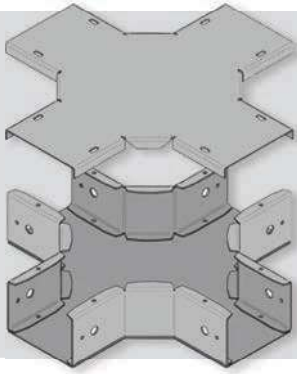

◀ **Flatwise Cross**
STK AC-1

Flatwise Tee ▶
STK AC-2

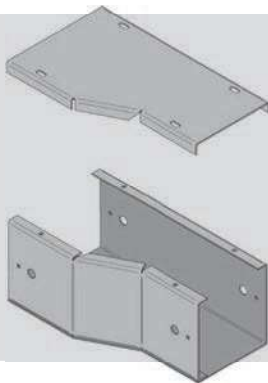
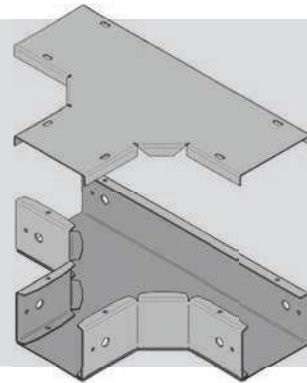

◀ **Righthand Reducer**
STK AC-3

Lefthand Reducer ▶
STK AC-4

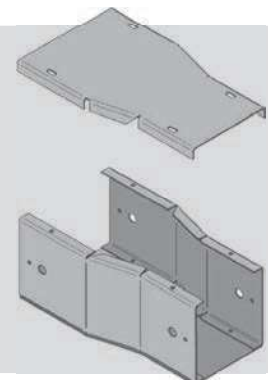
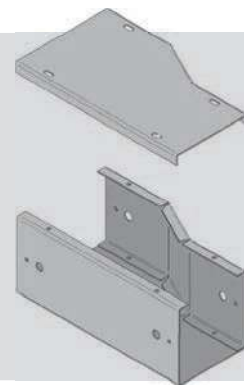

◀ **Straight Reducer**
STK AC-5

**Other design and sizes are available upon request.

Flatwise Elbow ▶
STK AC-6

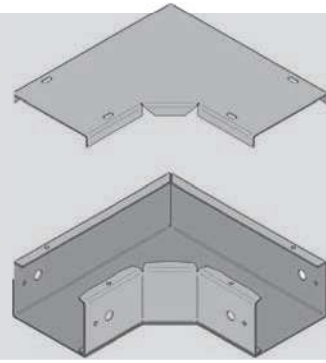

◀ Edgewise Elbow Left
STK AC-7

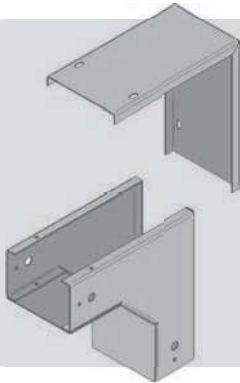

Edgewise Elbow Right ▶
STK AC-8

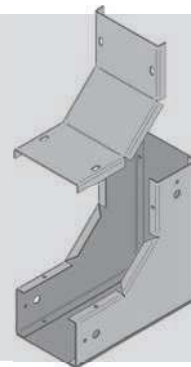

◀ Flatwise X Left STK AC-9

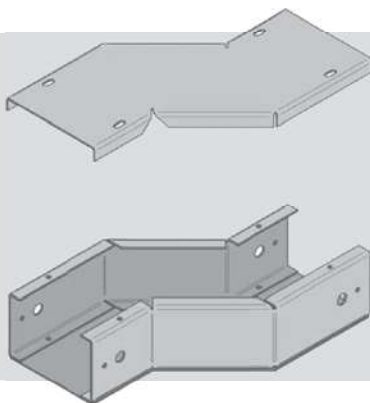

Flatwise X Right STK AC-10 ▶

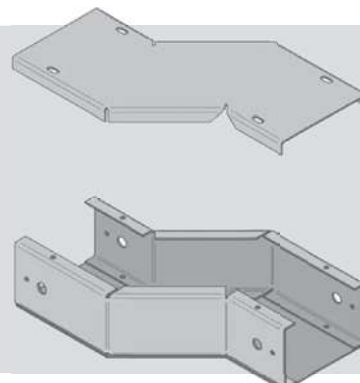

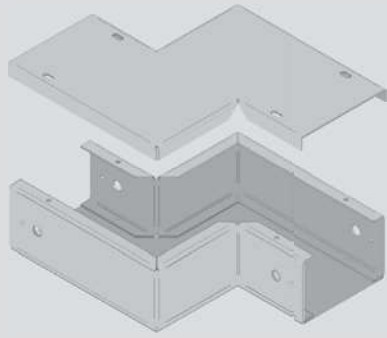

◀ **Flatwise X Reverse STK AC-11**

Flatwise Z STK AC-12 ▶

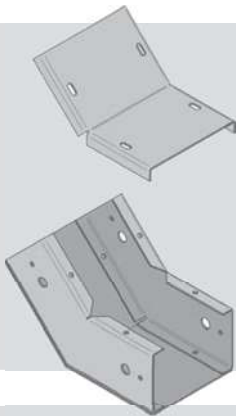
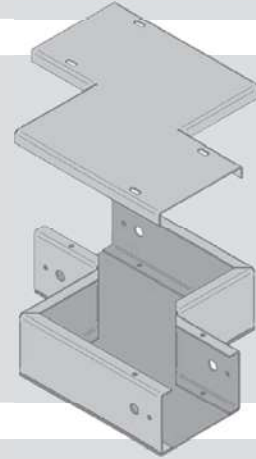

◀ **Elbow Bottom STK AC-13**

Elbow Top STK AC-14 ▶

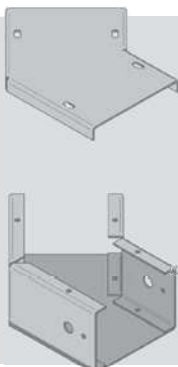
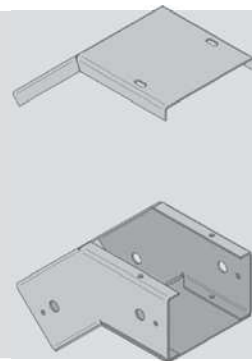

◀ **Elbow Front STK AC-15**

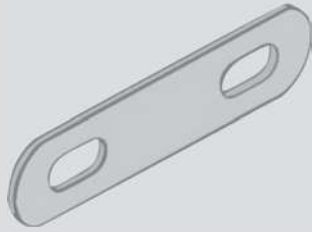

◀ **Earth Link STK AC-16**

Corner Outside Riser STK AC-17 ▶

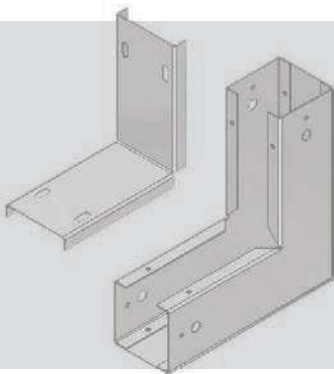
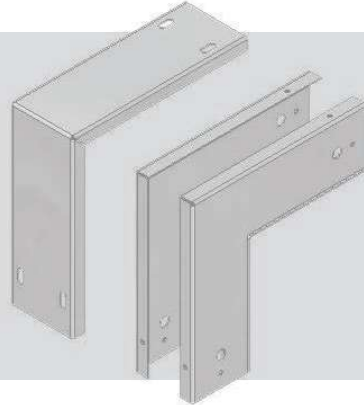

◀ **Corner Inside Riser STK AC-18**

Corner Elbow STK AC-19 ▶

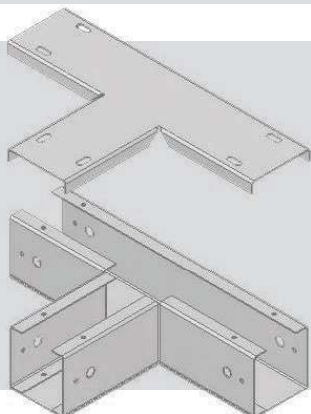
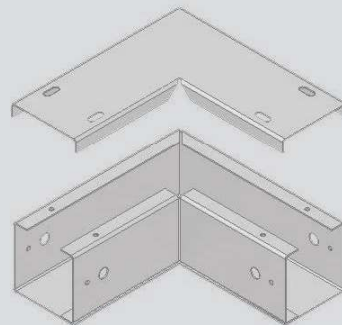

◀ **Corner Tee STK AC-20**

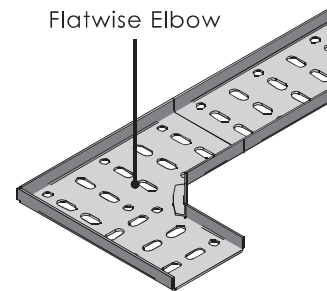
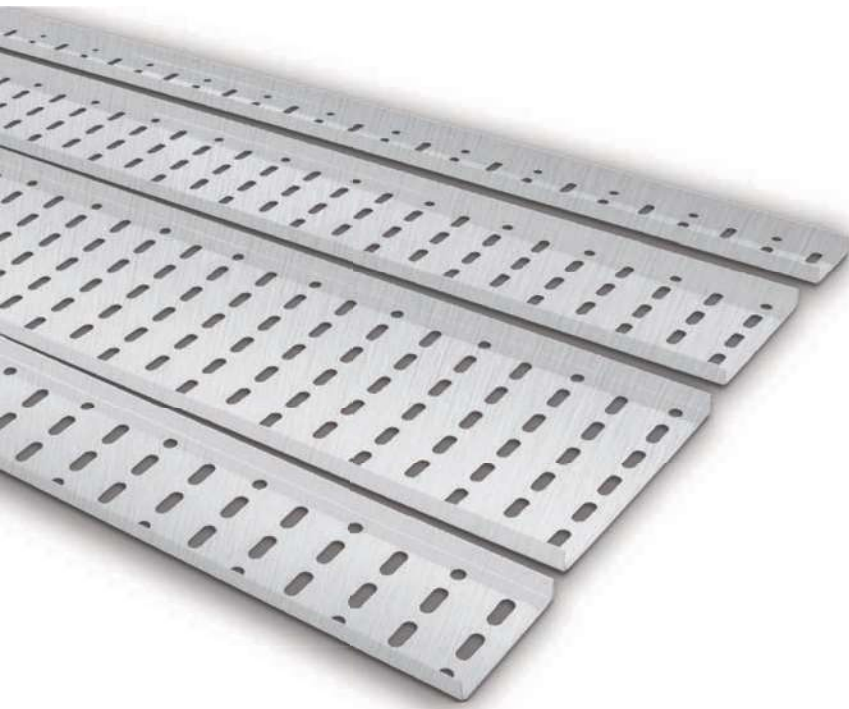

Perforated Cable Tray System

Cable tray is a unit or assembly of units or sections and associated fittings forming a rigid structural system used to securely fasten or support cables and raceways. Cable tray system is used to support insulated electrical cables used for power distribution, control, and communication. Cable trays are used as an alternative to open wiring or electrical conduit systems, and are commonly used for cable management in commercial and industrial construction. They are especially useful in situations where changes to a wiring system are anticipated, since new cables can be installed by laying them in the tray, instead of pulling them through a pipe.

Perforated Cable Tray Profile

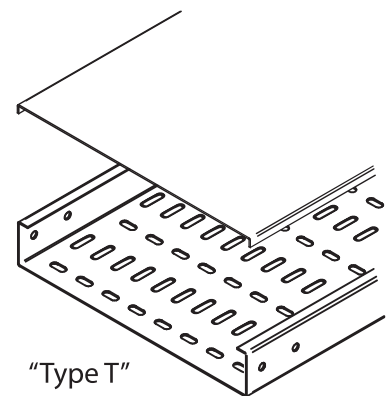
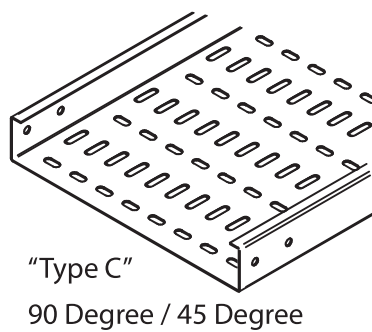
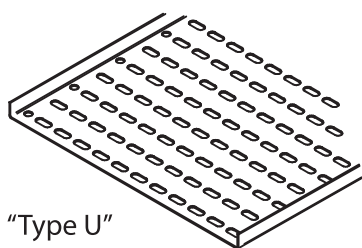
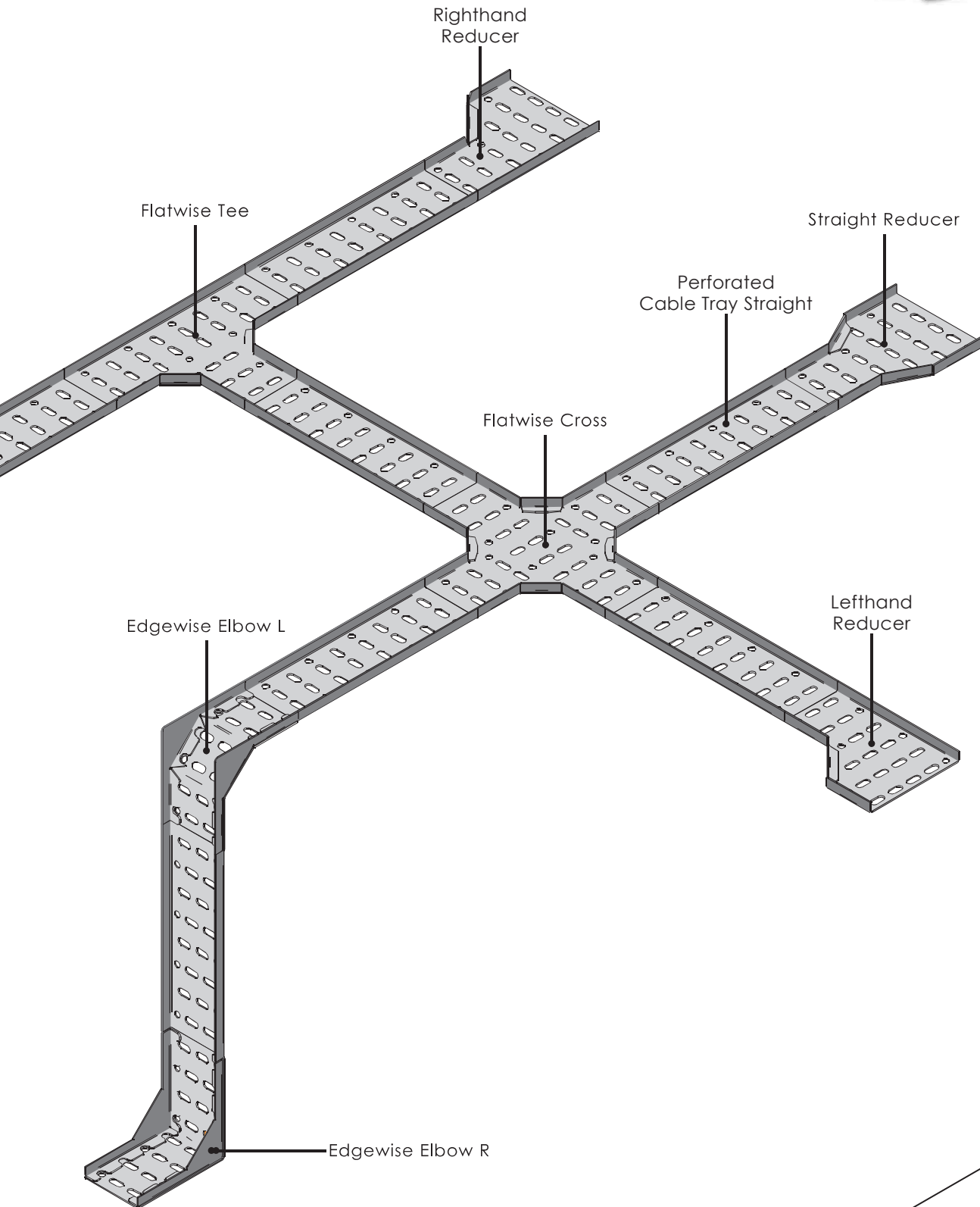

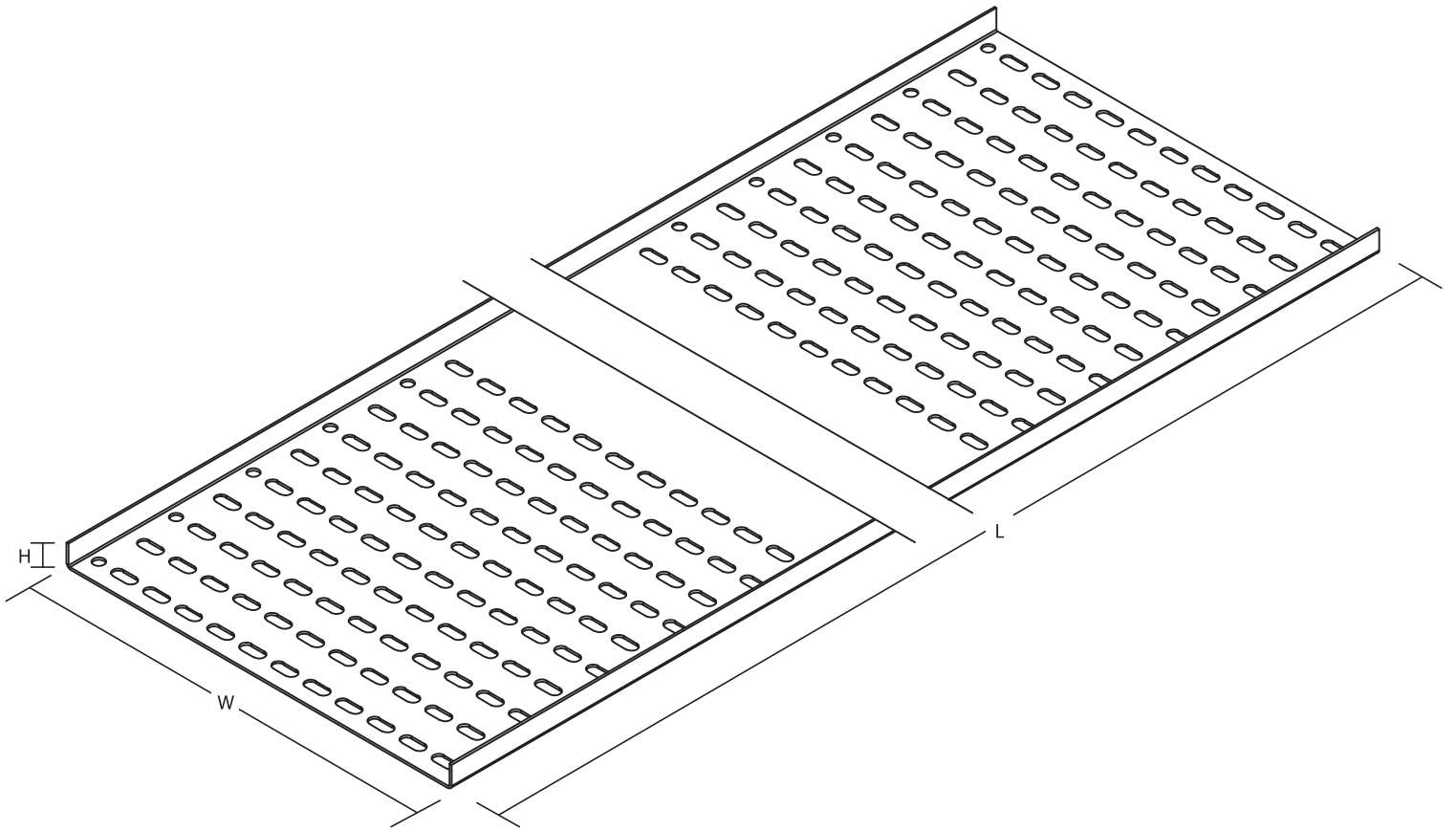

Dimension in Millimeter (mm)

L : Length
W : Width
H : Height

Perforated Cable Tray Straight "Type U"

Model	Nominal Size (mm)					
	Body (LxWxH)			Joint Plate (WxL)		Thickness
SCT/U-(50x13)	2438	50	13	43	150	1.5
SCT/U-(75x13)	2438	75	13	68	150	1.5
SCT/U-(100x13)	2438	100	13	93	150	1.5
SCT/U-(125x13)	2438	125	13	118	150	1.5
SCT/U-(150x13)	2438	150	13	143	150	1.5
SCT/U-(200x17)	2438	200	17	193	150	1.5
SCT/U-(250x17)	2438	250	17	243	150	1.5
SCT/U-(300x17)	2438	300	17	293	150	1.5
SCT/U-(350x20)	2438	350	20	342	150	2.0
SCT/U-(400x20)	2438	400	20	392	150	2.0
SCT/U-(450x20)	2438	450	20	442	150	2.0

**Specification subject to change without prior notice.

***Thickness Tolerance with + - 10%

*For order information, please refer page 63.

Perforated Cable Tray System

Perforated Cable Tray Straight "Type U"

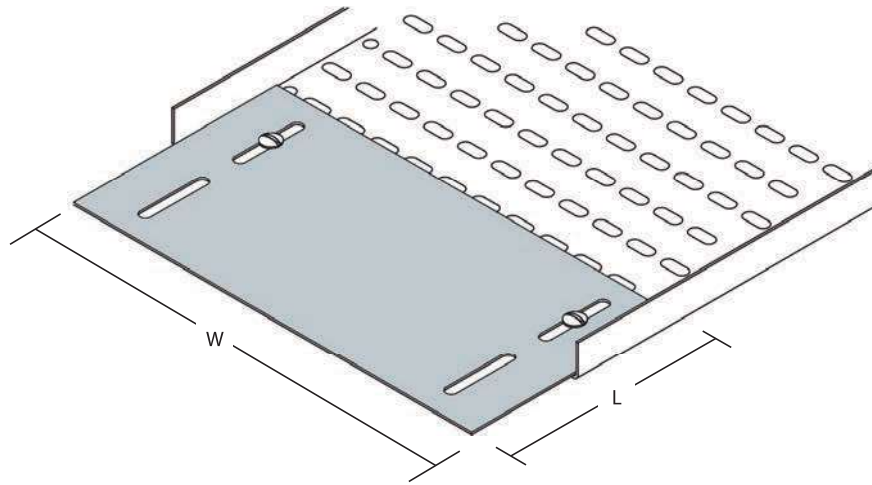

Joint Plate

*Separate purchase if need for tray joint plate



Dimension in Millimeter (mm)

L : Length
W : Width
H : Height

Perforated Cable Tray Straight "Type U"

Model	Nominal Size (mm)					
	Body (LxWxH)			Joint Plate (WxL)		Thickness
SCT/U-(500x25)	2438	500	25	492	150	2.0
SCT/U-(550x25)	2438	550	25	542	150	2.0
SCT/U-(600x25)	2438	600	25	592	150	2.0
SCT/U-(650x25)	2438	650	25	642	150	2.0
SCT/U-(700x25)	2438	700	25	692	150	2.0
SCT/U-(750x25)	2438	750	25	742	150	2.0
SCT/U-(800x25)	2438	800	25	792	150	2.0
SCT/U-(850x25)	2438	850	25	842	150	2.0
SCT/U-(900x25)	2438	900	25	892	150	2.0
SCT/U-(950x25)	2438	950	25	942	150	2.0
SCT/U-(1000x25)	2438	1000	25	992	150	2.0

**Specification subject to change without prior notice.

*For order information, please refer page 63.

***Thickness Tolerance with + - 10%

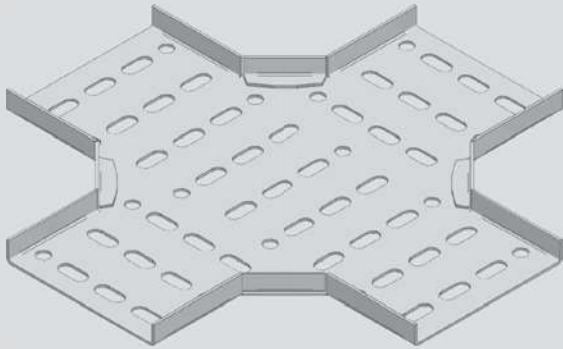

◀ **Flatwise Equal/Unequal Cross**
SCT/U AC-1

Flatwise Equal/Unequal Tee ▶
SCT/U AC-2

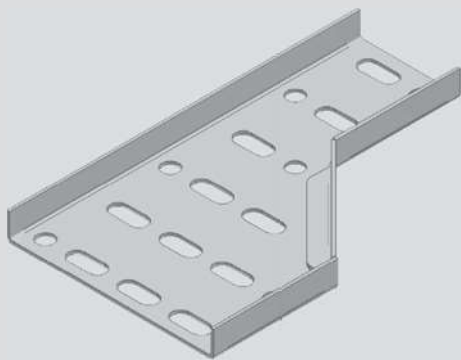
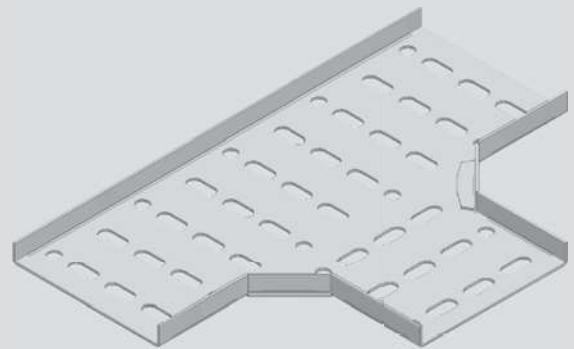

◀ **Righthand Reducer**
SCT/U AC-3

Lefthand Reducer ▶
SCT/U AC-4

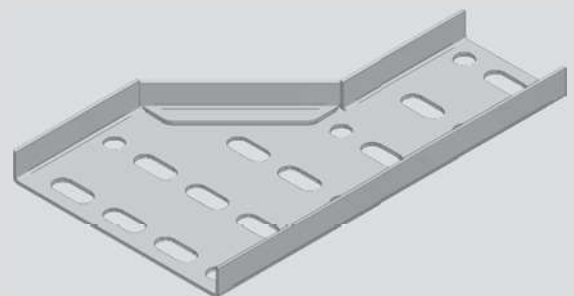

Type U 

**Other design and sizes are available upon request.

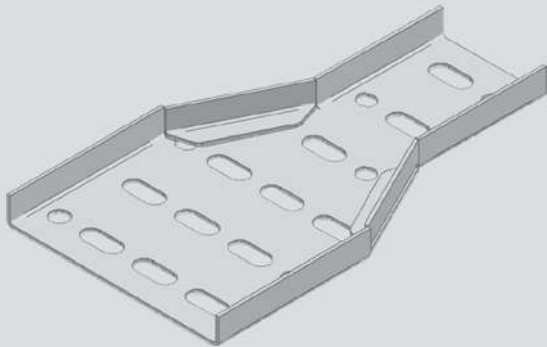

◀ **Straight Reducer**
SCT/U AC-5

Flatwise Elbow ▶
SCT/U AC-6

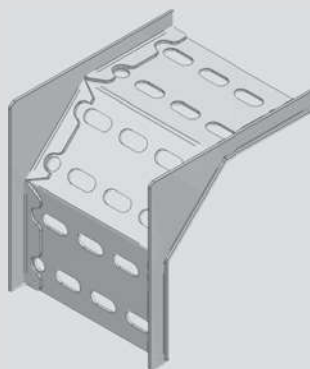
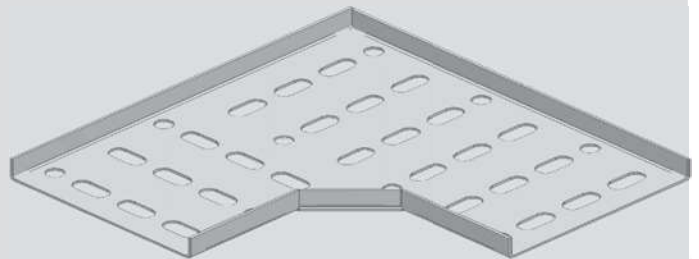

◀ **Edgewise Elbow Left**
SCT/U AC-7

Edgewise Elbow ▶
Right SCT/U AC-8

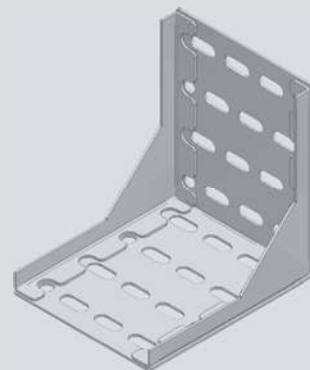

Type U

**Other design and sizes are available upon request.

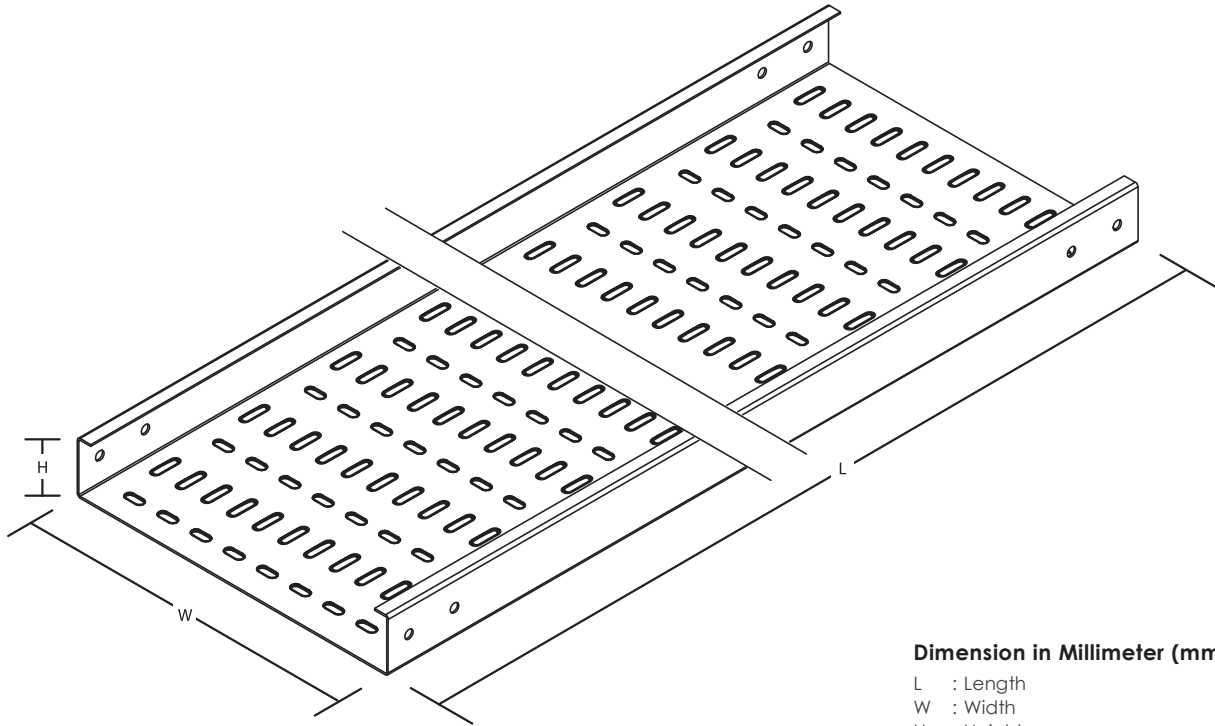

Dimension in Millimeter (mm)

L : Length
W : Width
H : Height

Perforated Cable Tray Straight "Type C" - 90 Degree (90D)

Model	Nominal Size (mm)		
	Body (LxWxH)	Splice Plate (H)	Thickness
SCT/C-(50X50)(90D)	2438 / 3000 x 50 x 50	42	1.5
SCT/C-(75X50)(90D)	2438 / 3000 x 75 x 50	42	1.5
SCT/C-(100X50)(90D)	2438 / 3000 x 100 x 50	42	1.5
SCT/C-(150X50)(90D)	2438 / 3000 x 150 x 50	42	1.5
SCT/C-(200X50)(90D)	2438 / 3000 x 200 x 50	42	1.5
SCT/C-(250X50)(90D)	2438 / 3000 x 250 x 50	42	1.5
SCT/C-(300X50)(90D)	2438 / 3000 x 300 x 50	42	1.5
SCT/C-(350X50)(90D)	2438 / 3000 x 350 x 50	42	2.0
SCT/C-(400X50)(90D)	2438 / 3000 x 400 x 50	42	2.0
SCT/C-(450X50)(90D)	2438 / 3000 x 450 x 50	42	2.0
SCT/C-(500X50)(90D)	2438 / 3000 x 500 x 50	42	2.0
SCT/C-(550X50)(90D)	2438 / 3000 x 550 x 50	42	2.0
SCT/C-(600X50)(90D)	2438 / 3000 x 600 x 50	42	2.0
SCT/C-(650X50)(90D)	2438 / 3000 x 650 x 50	42	2.0
SCT/C-(700X50)(90D)	2438 / 3000 x 700 x 50	42	2.0
SCT/C-(750X50)(90D)	2438 / 3000 x 750 x 50	42	2.0
SCT/C-(800X50)(90D)	2438 / 3000 x 800 x 50	42	2.0
SCT/C-(850X50)(90D)	2438 / 3000 x 850 x 50	42	2.0
SCT/C-(900X50)(90D)	2438 / 3000 x 900 x 50	42	2.0
SCT/C-(950X50)(90D)	2438 / 3000 x 950 x 50	42	2.0
SCT/C-(1000X50)(90D)	2438 / 3000 x 1000 x 50	42	2.0
SCT/C-(75X75)(90D)	2438 / 3000 x 75 x 75	67	1.5
SCT/C-(100X75)(90D)	2438 / 3000 x 100 x 75	67	1.5
SCT/C-(150X75)(90D)	2438 / 3000 x 150 x 75	67	1.5
SCT/C-(200X75)(90D)	2438 / 3000 x 200 x 75	67	1.5
SCT/C-(250X75)(90D)	2438 / 3000 x 250 x 75	67	1.5
SCT/C-(300X75)(90D)	2438 / 3000 x 300 x 75	67	1.5
SCT/C-(350X75)(90D)	2438 / 3000 x 350 x 75	67	2.0
SCT/C-(400X75)(90D)	2438 / 3000 x 400 x 75	67	2.0
SCT/C-(450X75)(90D)	2438 / 3000 x 450 x 75	67	2.0

**Specification subject to change without prior notice.
***Thickness Tolerance with + - 10%

*For order information, please refer page 63.

Perforated Cable Tray System

Perforated Cable Tray Straight "Type C" 90 Degree (90D)

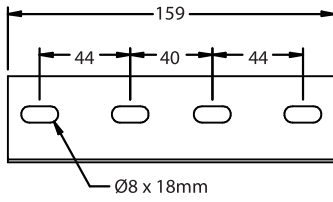
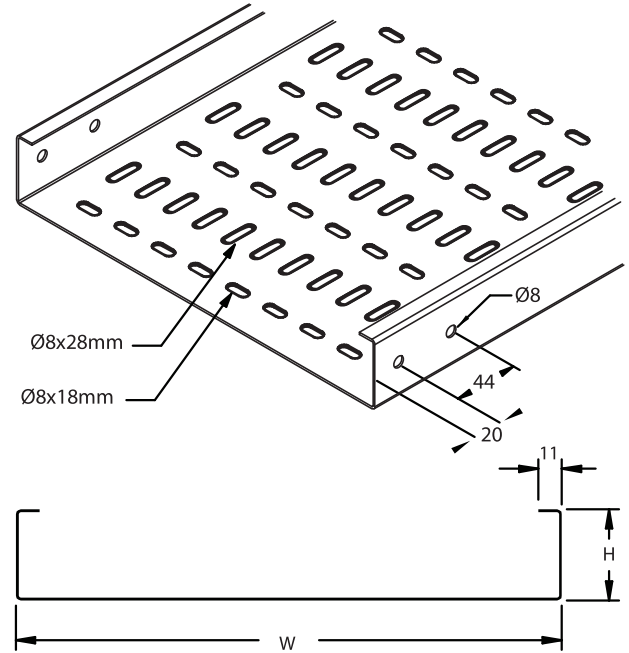
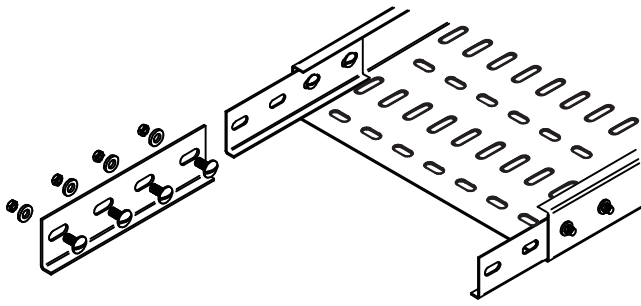

Splice Plate

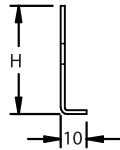

Perforated Cable Tray Straight "Type C" - 90 Degree (90D)

Model	Nominal Size (mm)		
	Body (LxWxH)	Splice Plate (H)	Thickness
SCT/C-(500X75)(90D)	2438 / 3000 x 500 x 75	67	2.0
SCT/C-(550X75)(90D)	2438 / 3000 x 550 x 75	67	2.0
SCT/C-(600X75)(90D)	2438 / 3000 x 600 x 75	67	2.0
SCT/C-(650X75)(90D)	2438 / 3000 x 650 x 75	67	2.0
SCT/C-(700X75)(90D)	2438 / 3000 x 700 x 75	67	2.0
SCT/C-(750X75)(90D)	2438 / 3000 x 750 x 75	67	2.0
SCT/C-(800X75)(90D)	2438 / 3000 x 800 x 75	67	2.0
SCT/C-(850X75)(90D)	2438 / 3000 x 850 x 75	67	2.0
SCT/C-(900X75)(90D)	2438 / 3000 x 900 x 75	67	2.0
SCT/C-(950X75)(90D)	2438 / 3000 x 950 x 75	67	2.0
SCT/C-(1000X75)(90D)	2438 / 3000 x 1000 x 75	67	2.0
SCT/C-(100X100)(90D)	2438 / 3000 x 100 x 100	92	1.5
SCT/C-(150X100)(90D)	2438 / 3000 x 150 x 100	92	1.5
SCT/C-(200X100)(90D)	2438 / 3000 x 200 x 100	92	1.5
SCT/C-(250X100)(90D)	2438 / 3000 x 250 x 100	92	1.5
SCT/C-(300X100)(90D)	2438 / 3000 x 300 x 100	92	1.5
SCT/C-(350X100)(90D)	2438 / 3000 x 350 x 100	92	2.0
SCT/C-(400X100)(90D)	2438 / 3000 x 400 x 100	92	2.0
SCT/C-(450X100)(90D)	2438 / 3000 x 450 x 100	92	2.0
SCT/C-(500X100)(90D)	2438 / 3000 x 500 x 100	92	2.0
SCT/C-(550X100)(90D)	2438 / 3000 x 550 x 100	92	2.0
SCT/C-(600X100)(90D)	2438 / 3000 x 600 x 100	92	2.0
SCT/C-(650X100)(90D)	2438 / 3000 x 650 x 100	92	2.0
SCT/C-(700X100)(90D)	2438 / 3000 x 700 x 100	92	2.0
SCT/C-(750X100)(90D)	2438 / 3000 x 750 x 100	92	2.0
SCT/C-(800X100)(90D)	2438 / 3000 x 800 x 100	92	2.0
SCT/C-(850X100)(90D)	2438 / 3000 x 850 x 100	92	2.0
SCT/C-(900X100)(90D)	2438 / 3000 x 900 x 100	92	2.0
SCT/C-(950X100)(90D)	2438 / 3000 x 950 x 100	92	2.0
SCT/C-(1000X100)(90D)	2438 / 3000 x 1000 x 100	92	2.0

**Specification subject to change without prior notice.
 ***Thickness Tolerance with + - 10%

*For order information, please refer page 63.

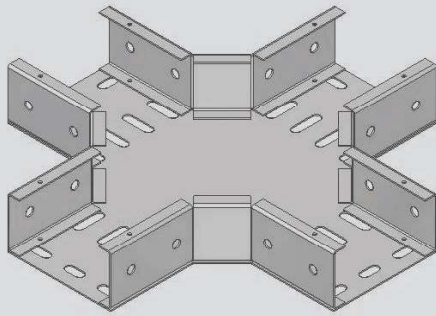

◀ **Flatwise Equal/Unequal Cross**
SCT/C (90D) AC-1

Flatwise Equal/Unequal Tee ▶
SCT/C (90D) AC-2

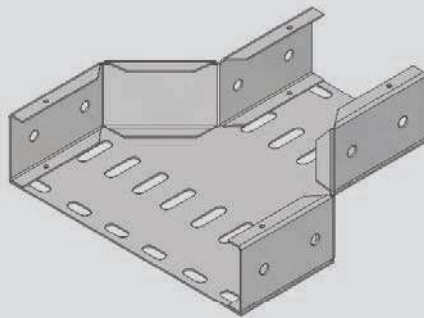
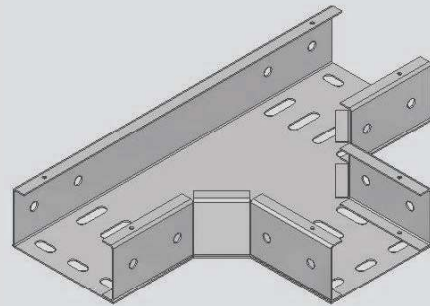

◀ **Straight Reducer**
SCT/C (90D) AC-5

Flatwise Elbow ▶
SCT/C (90D) AC-6

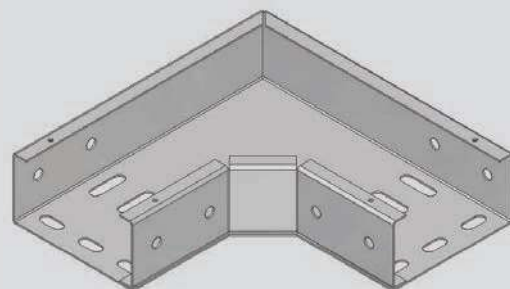

**Other design and sizes are available upon request.

"Type C" (90D) 

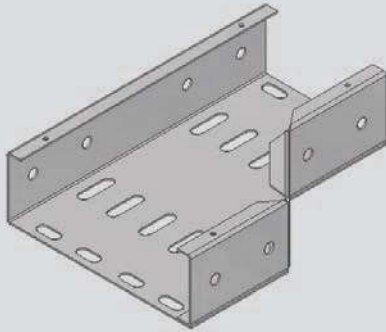

◀ **Righthand Reducer**
SCT/C (90D) AC-3

Lefthand Reducer ▶
SCT/C (90D) AC-4

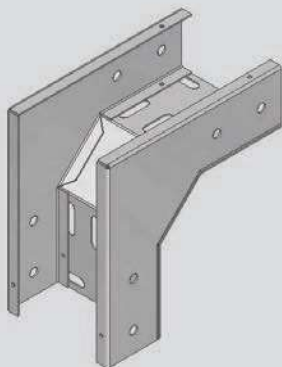
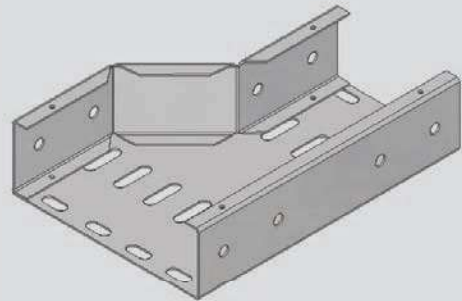

◀ **Edgewise Elbow Left**
SCT/C (90D) AC-7

Edgewise Elbow Right ▶
SCT/C (90D) AC-8

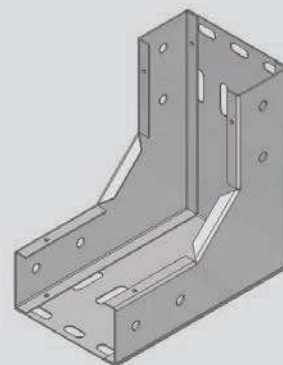

**Other design and sizes are available upon request.

"Type C" (90D) 

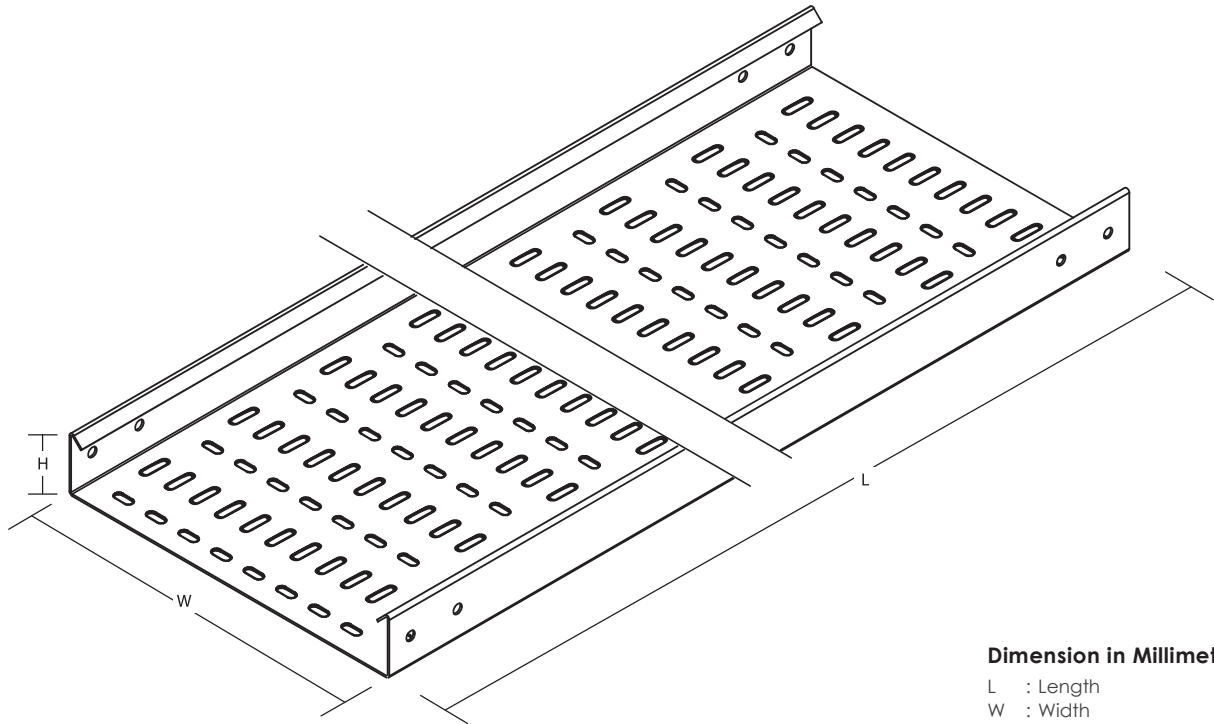

Dimension in Millimeter (mm)

L : Length
W : Width
H : Height

Perforated Cable Tray Straight "Type C" - 45 Degree (45D)

Model	Nominal Size (mm)		
	Body (LxWxH)	Splice Plate (H)	Thickness
SCT/C-(50X50)(45D)	2438 / 3000 x 50 x 50	42	1.5
SCT/C-(75X50)(45D)	2438 / 3000 x 75 x 50	42	1.5
SCT/C-(100X50)(45D)	2438 / 3000 x 100 x 50	42	1.5
SCT/C-(150X50)(45D)	2438 / 3000 x 150 x 50	42	1.5
SCT/C-(200X50)(45D)	2438 / 3000 x 200 x 50	42	1.5
SCT/C-(250X50)(45D)	2438 / 3000 x 250 x 50	42	1.5
SCT/C-(300X50)(45D)	2438 / 3000 x 300 x 50	42	1.5
SCT/C-(350X50)(45D)	2438 / 3000 x 350 x 50	42	2.0
SCT/C-(400X50)(45D)	2438 / 3000 x 400 x 50	42	2.0
SCT/C-(450X50)(45D)	2438 / 3000 x 450 x 50	42	2.0
SCT/C-(500X50)(45D)	2438 / 3000 x 500 x 50	42	2.0
SCT/C-(550X50)(45D)	2438 / 3000 x 550 x 50	42	2.0
SCT/C-(600X50)(45D)	2438 / 3000 x 600 x 50	42	2.0
SCT/C-(650X50)(45D)	2438 / 3000 x 650 x 50	42	2.0
SCT/C-(700X50)(45D)	2438 / 3000 x 700 x 50	42	2.0
SCT/C-(750X50)(45D)	2438 / 3000 x 750 x 50	42	2.0
SCT/C-(800X50)(45D)	2438 / 3000 x 800 x 50	42	2.0
SCT/C-(850X50)(45D)	2438 / 3000 x 850 x 50	42	2.0
SCT/C-(900X50)(45D)	2438 / 3000 x 900 x 50	42	2.0
SCT/C-(950X50)(45D)	2438 / 3000 x 950 x 50	42	2.0
SCT/C-(1000X50)(45D)	2438 / 3000 x 1000 x 50	42	2.0
SCT/C-(75X75)(45D)	2438 / 3000 x 75 x 75	67	1.5
SCT/C-(100X75)(45D)	2438 / 3000 x 100 x 75	67	1.5
SCT/C-(150X75)(45D)	2438 / 3000 x 150 x 75	67	1.5
SCT/C-(200X75)(45D)	2438 / 3000 x 200 x 75	67	1.5
SCT/C-(250X75)(45D)	2438 / 3000 x 250 x 75	67	1.5
SCT/C-(300X75)(45D)	2438 / 3000 x 300 x 75	67	1.5
SCT/C-(350X75)(45D)	2438 / 3000 x 350 x 75	67	2.0
SCT/C-(400X75)(45D)	2438 / 3000 x 400 x 75	67	2.0
SCT/C-(450X75)(45D)	2438 / 3000 x 450 x 75	67	2.0

**Specification subject to change without prior notice.
***Thickness Tolerance with + - 10%

*For order information, please refer page 63.

Perforated Cable Tray System

Perforated Cable Tray Straight "Type C" 45 Degree (45D)

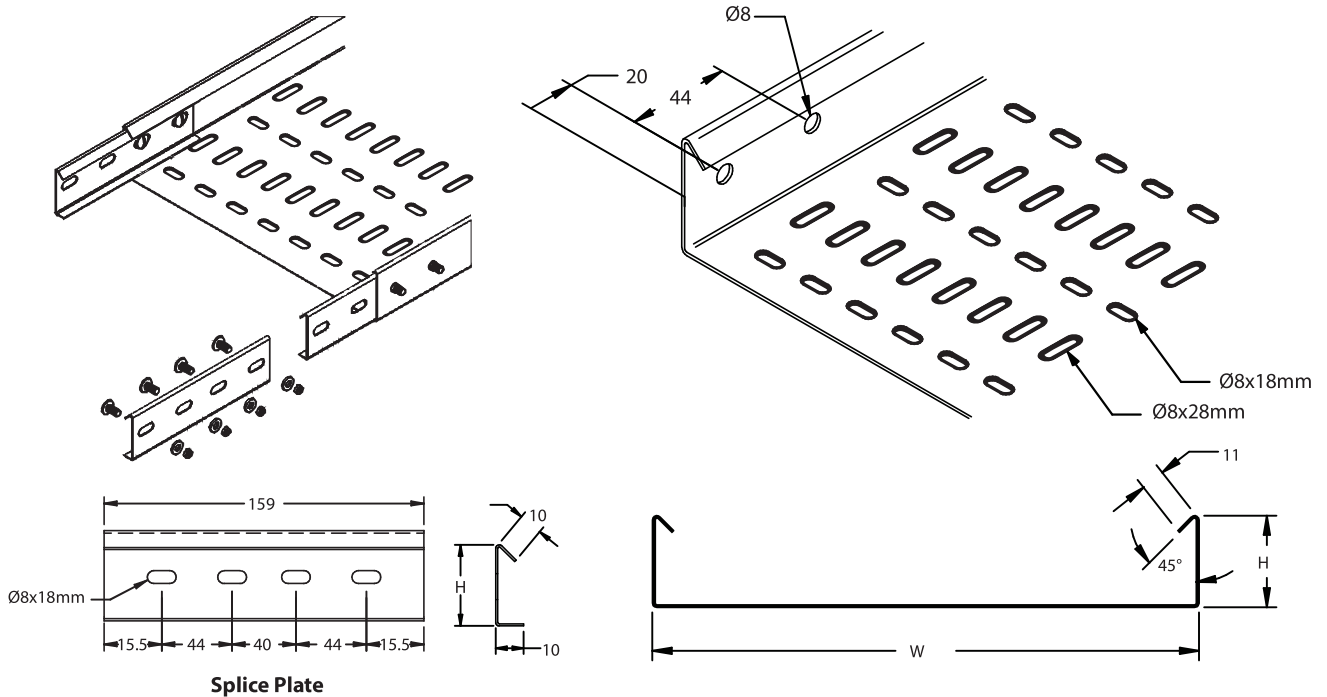

Perforated Cable Tray Straight "Type C" - 45 Degree (45D)

Model	Nominal Size (mm)		
	Body (LxWxH)	Splice Plate (H)	Thickness
SCT/C-(500X75)(45D)	2438 / 3000 x 500 x 75	67	2.0
SCT/C-(550X75)(45D)	2438 / 3000 x 550 x 75	67	2.0
SCT/C-(600X75)(45D)	2438 / 3000 x 600 x 75	67	2.0
SCT/C-(650X75)(45D)	2438 / 3000 x 650 x 75	67	2.0
SCT/C-(700X75)(45D)	2438 / 3000 x 700 x 75	67	2.0
SCT/C-(750X75)(45D)	2438 / 3000 x 750 x 75	67	2.0
SCT/C-(800X75)(45D)	2438 / 3000 x 800 x 75	67	2.0
SCT/C-(850X75)(45D)	2438 / 3000 x 850 x 75	67	2.0
SCT/C-(900X75)(45D)	2438 / 3000 x 900 x 75	67	2.0
SCT/C-(950X75)(45D)	2438 / 3000 x 950 x 75	67	2.0
SCT/C-(1000X75)(45D)	2438 / 3000 x 1000 x 75	67	2.0
SCT/C-(100X100)(45D)	2438 / 3000 x 100 x 100	92	1.5
SCT/C-(150X100)(45D)	2438 / 3000 x 150 x 100	92	1.5
SCT/C-(200X100)(45D)	2438 / 3000 x 200 x 100	92	1.5
SCT/C-(250X100)(45D)	2438 / 3000 x 250 x 100	92	1.5
SCT/C-(300X100)(45D)	2438 / 3000 x 300 x 100	92	1.5
SCT/C-(350X100)(45D)	2438 / 3000 x 350 x 100	92	2.0
SCT/C-(400X100)(45D)	2438 / 3000 x 400 x 100	92	2.0
SCT/C-(450X100)(45D)	2438 / 3000 x 450 x 100	92	2.0
SCT/C-(500X100)(45D)	2438 / 3000 x 500 x 100	92	2.0
SCT/C-(550X100)(45D)	2438 / 3000 x 550 x 100	92	2.0
SCT/C-(600X100)(45D)	2438 / 3000 x 600 x 100	92	2.0
SCT/C-(650X100)(45D)	2438 / 3000 x 650 x 100	92	2.0
SCT/C-(700X100)(45D)	2438 / 3000 x 700 x 100	92	2.0
SCT/C-(750X100)(45D)	2438 / 3000 x 750 x 100	92	2.0
SCT/C-(800X100)(45D)	2438 / 3000 x 800 x 100	92	2.0
SCT/C-(850X100)(45D)	2438 / 3000 x 850 x 100	92	2.0
SCT/C-(900X100)(45D)	2438 / 3000 x 900 x 100	92	2.0
SCT/C-(950X100)(45D)	2438 / 3000 x 950 x 100	92	2.0
SCT/C-(1000X100)(45D)	2438 / 3000 x 1000 x 100	92	2.0

**Specification subject to change without prior notice.
 ***Thickness Tolerance with + - 10%

*For order information, please refer page 63.

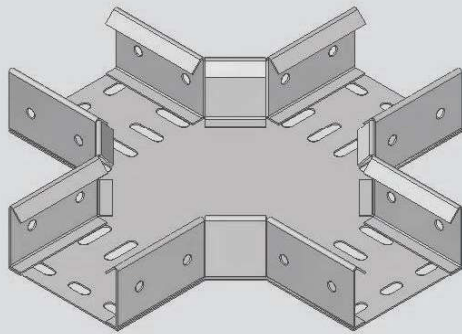

◀ **Flatwise Equal/Unequal Cross**
SCT/C (45D) AC-1

Flatwise Equal/Unequal Tee ▶
SCT/C (45D) AC-2

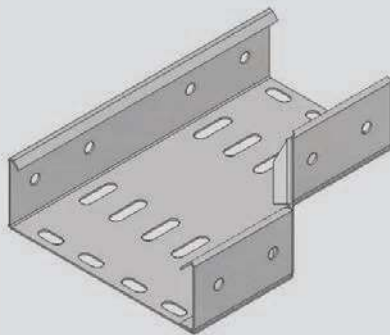
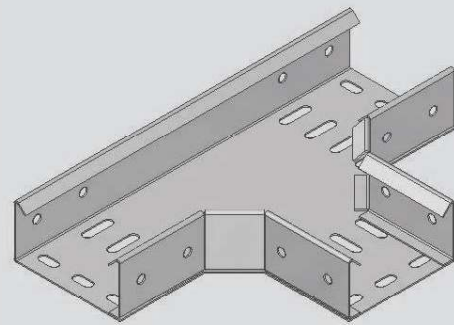

◀ **Righthand Reducer**
SCT/C (45D) AC-3

Lefthand Reducer ▶
SCT/C (45D) AC-4

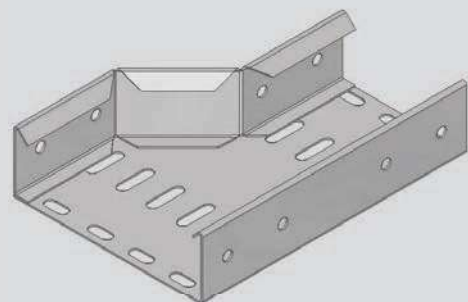

**Other design and sizes are available upon request.

"Type C" (45D)

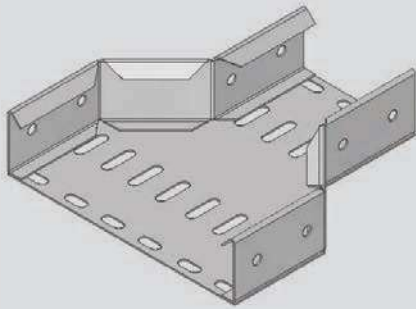

◀ **Straight Reducer**
SCT/C (45D) AC-5

Flatwise Elbow ▶
SCT/C (45D) AC-6

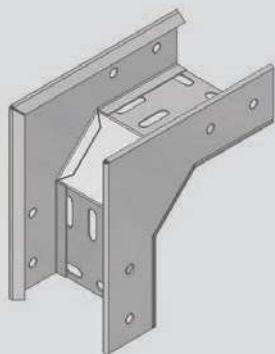
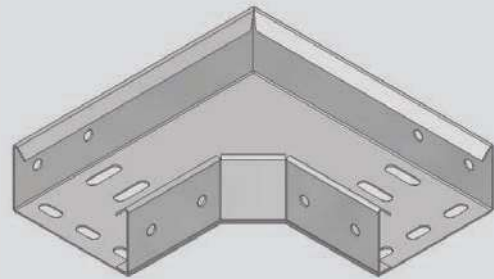

◀ **Edgewise Elbow Left**
SCT/C (45D) AC-7

Edgewise Elbow Right ▶
SCT/C (45D) AC-8

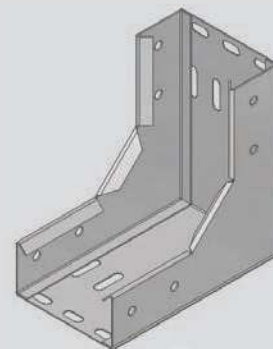

**Other design and sizes are available upon request.

"Type C" (45D) 

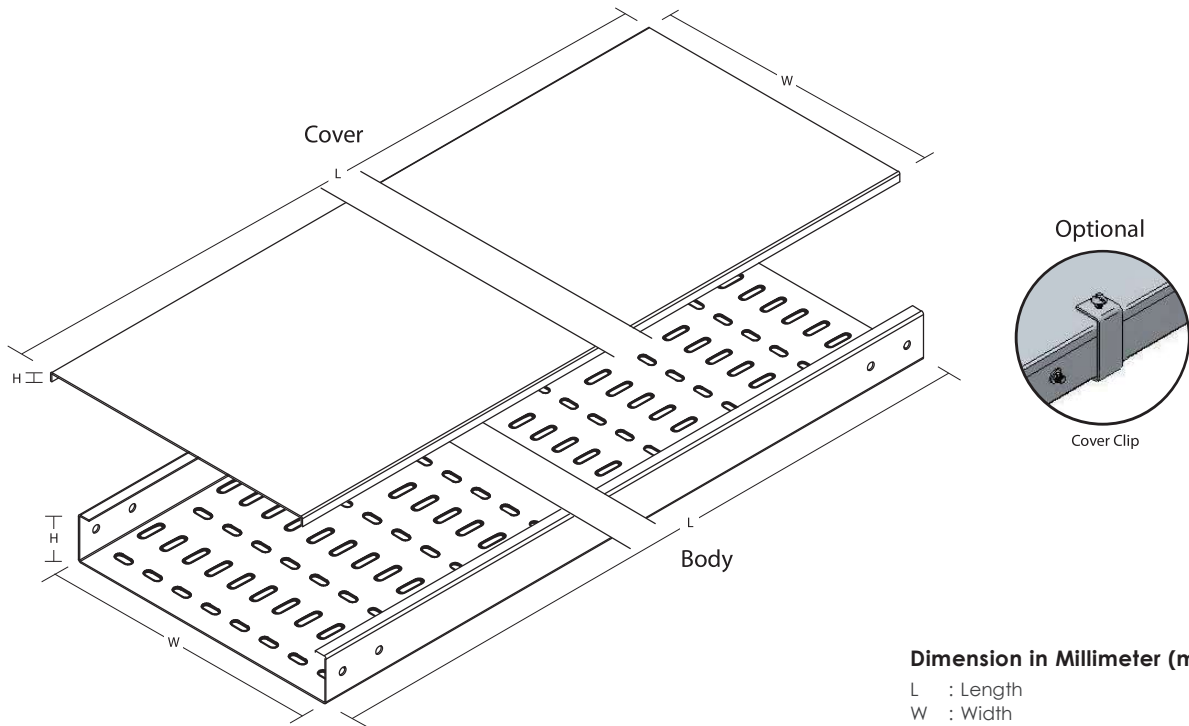

Dimension in Millimeter (mm)

L : Length
W : Width
H : Height

Perforated Cable Tray Straight "Type T"

Model	Nominal Size (mm)			
	Body (LxWxH)	Cover (WxH)	Splice Plate (H)	Thickness
SCT/T-(50X50)	2438 / 3000 x 50 x 50	55 x 11	42	1.5
SCT/T-(75X50)	2438 / 3000 x 75 x 50	80 x 11	42	1.5
SCT/T-(100X50)	2438 / 3000 x 100 x 50	105 x 11	42	1.5
SCT/T-(150X50)	2438 / 3000 x 150 x 50	155 x 11	42	1.5
SCT/T-(200X50)	2438 / 3000 x 200 x 50	205 x 11	42	1.5
SCT/T-(250X50)	2438 / 3000 x 250 x 50	255 x 11	42	1.5
SCT/T-(300X50)	2438 / 3000 x 300 x 50	305 x 11	42	1.5
SCT/T-(350X50)	2438 / 3000 x 350 x 50	356 x 11	42	2.0
SCT/T-(400X50)	2438 / 3000 x 400 x 50	406 x 11	42	2.0
SCT/T-(450X50)	2438 / 3000 x 450 x 50	456 x 11	42	2.0
SCT/T-(500X50)	2438 / 3000 x 500 x 50	506 x 11	42	2.0
SCT/T-(550X50)	2438 / 3000 x 550 x 50	556 x 11	42	2.0
SCT/T-(600X50)	2438 / 3000 x 600 x 50	606 x 11	42	2.0
SCT/T-(650X50)	2438 / 3000 x 650 x 50	656 x 11	42	2.0
SCT/T-(700X50)	2438 / 3000 x 700 x 50	706 x 11	42	2.0
SCT/T-(750X50)	2438 / 3000 x 750 x 50	756 x 11	42	2.0
SCT/T-(800X50)	2438 / 3000 x 800 x 50	806 x 11	42	2.0
SCT/T-(850X50)	2438 / 3000 x 850 x 50	856 x 11	42	2.0
SCT/T-(900X50)	2438 / 3000 x 900 x 50	906 x 11	42	2.0
SCT/T-(950X50)	2438 / 3000 x 950 x 50	956 x 11	42	2.0
SCT/T-(1000X50)	2438 / 3000 x 1000 x 50	1006 x 11	42	2.0
SCT/T-(75X75)	2438 / 3000 x 75 x 75	80 x 11	67	1.5
SCT/T-(100X75)	2438 / 3000 x 100 x 75	105 x 11	67	1.5
SCT/T-(150X75)	2438 / 3000 x 150 x 75	155 x 11	67	1.5
SCT/T-(200X75)	2438 / 3000 x 200 x 75	205 x 11	67	1.5
SCT/T-(250X75)	2438 / 3000 x 250 x 75	255 x 11	67	1.5
SCT/T-(300X75)	2438 / 3000 x 300 x 75	305 x 11	67	1.5
SCT/T-(350X75)	2438 / 3000 x 350 x 75	356 x 11	67	2.0
SCT/T-(400X75)	2438 / 3000 x 400 x 75	406 x 11	67	2.0
SCT/T-(450X75)	2438 / 3000 x 450 x 75	456 x 11	67	2.0

**Specification subject to change without prior notice.
***Thickness Tolerance with + - 10%

*For order information, please refer page 63.

Perforated Cable Tray System

Cable Tray Straight "Type T"

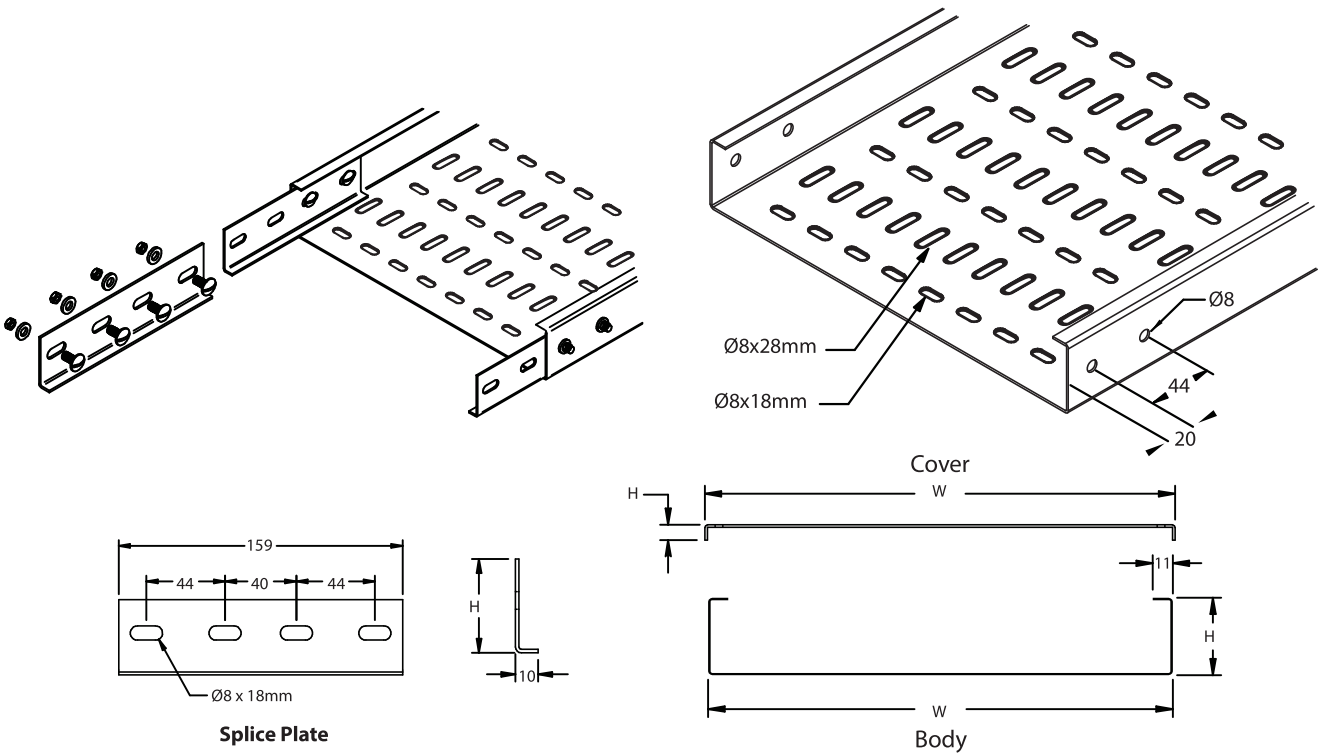

Perforated Cable Tray Straight "Type T"

Model	Nominal Size (mm)			
	Body (LxWxH)	Cover (WxH)	Splice Plate (H)	Thickness
SCT/T-(500X75)	2438 / 3000 x 500 x 75	506 x 11	67	2.0
SCT/T-(550X75)	2438 / 3000 x 550 x 75	556 x 11	67	2.0
SCT/T-(600X75)	2438 / 3000 x 600 x 75	606 x 11	67	2.0
SCT/T-(650X75)	2438 / 3000 x 650 x 75	656 x 11	67	2.0
SCT/T-(700X75)	2438 / 3000 x 700 x 75	706 x 11	67	2.0
SCT/T-(750X75)	2438 / 3000 x 750 x 75	756 x 11	67	2.0
SCT/T-(800X75)	2438 / 3000 x 800 x 75	806 x 11	67	2.0
SCT/T-(850X75)	2438 / 3000 x 850 x 75	856 x 11	67	2.0
SCT/T-(900X75)	2438 / 3000 x 900 x 75	906 x 11	67	2.0
SCT/T-(950X75)	2438 / 3000 x 950 x 75	956 x 11	67	2.0
SCT/T-(1000X75)	2438 / 3000 x 1000 x 75	1006 x 11	67	2.0
SCT/T-(100X100)	2438 / 3000 x 100 x 100	105 x 11	92	1.5
SCT/T-(150X100)	2438 / 3000 x 150 x 100	155 x 11	92	1.5
SCT/T-(200X100)	2438 / 3000 x 200 x 100	205 x 11	92	1.5
SCT/T-(250X100)	2438 / 3000 x 250 x 100	255 x 11	92	1.5
SCT/T-(300X100)	2438 / 3000 x 300 x 100	305 x 11	92	1.5
SCT/T-(350X100)	2438 / 3000 x 350 x 100	356 x 11	92	2.0
SCT/T-(400X100)	2438 / 3000 x 400 x 100	406 x 11	92	2.0
SCT/T-(450X100)	2438 / 3000 x 450 x 100	456 x 11	92	2.0
SCT/T-(500X100)	2438 / 3000 x 500 x 100	506 x 11	92	2.0
SCT/T-(550X100)	2438 / 3000 x 550 x 100	556 x 11	92	2.0
SCT/T-(600X100)	2438 / 3000 x 600 x 100	606 x 11	92	2.0
SCT/T-(650X100)	2438 / 3000 x 650 x 100	656 x 11	92	2.0
SCT/T-(700X100)	2438 / 3000 x 700 x 100	706 x 11	92	2.0
SCT/T-(750X100)	2438 / 3000 x 750 x 100	756 x 11	92	2.0
SCT/T-(800X100)	2438 / 3000 x 800 x 100	806 x 11	92	2.0
SCT/T-(850X100)	2438 / 3000 x 850 x 100	856 x 11	92	2.0
SCT/T-(900X100)	2438 / 3000 x 900 x 100	906 x 11	92	2.0
SCT/T-(950X100)	2438 / 3000 x 950 x 100	956 x 11	92	2.0
SCT/T-(1000X100)	2438 / 3000 x 1000 x 100	1006 x 11	92	2.0

**Specification subject to change without prior notice.
 ***Thickness Tolerance with + - 10%

*For order information, please refer page 63.

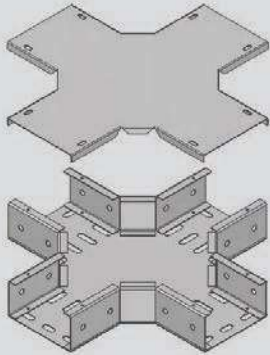

◀ **Flatwise Cross**
SCT/T (90D) AC-1

Flatwise Tee ▶
SCT/T (90D) AC-2

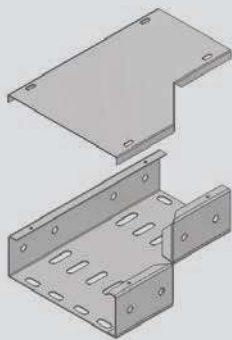
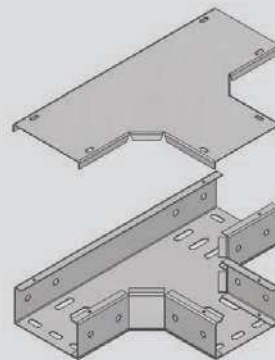

◀ **Righthand Reducer**
SCT/T AC-3

Lefthand Reducer ▶
SCT/T AC-4

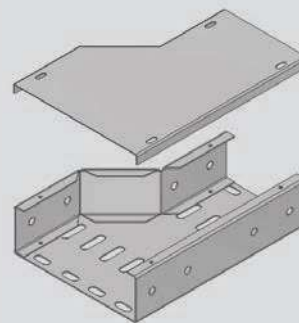

**Other design and sizes are available upon request.

"Type T" 

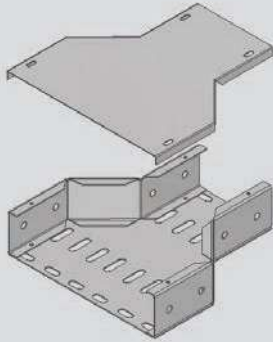

◀ **Straight Reducer**
SCT/T AC-5

Flatwise Elbow ▶
SCT/T (90D) AC-6

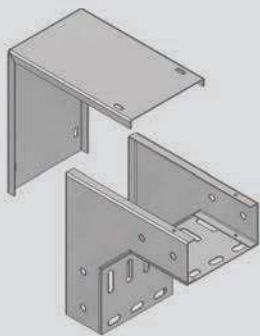
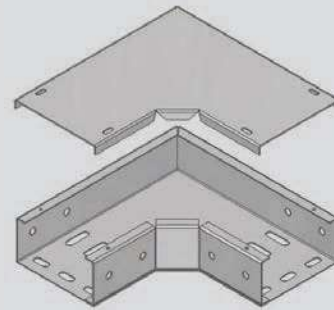

◀ **Edgewise Elbow Left**
SCT/T AC-7

Edgewise Elbow Right ▶
SCT/T (90D) AC-8

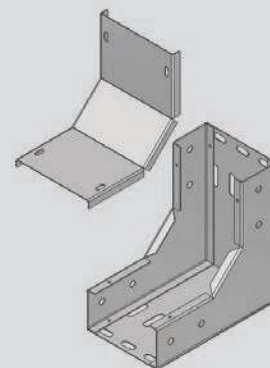

**Other design and sizes are available upon request.

“Type T” 

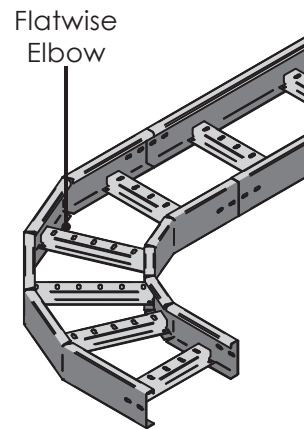

Cable Ladder System

Cable ladder is system component used for cable support consisting of supporting side members, fixed to each other by means of rungs. Cable ladder is typically of stronger built and able to carry more load. The configuration is easy thus less accessories are required. One of the design advantages is it can get cable drops through the rungs and an extra riser is not required.

Cable Ladder Profile

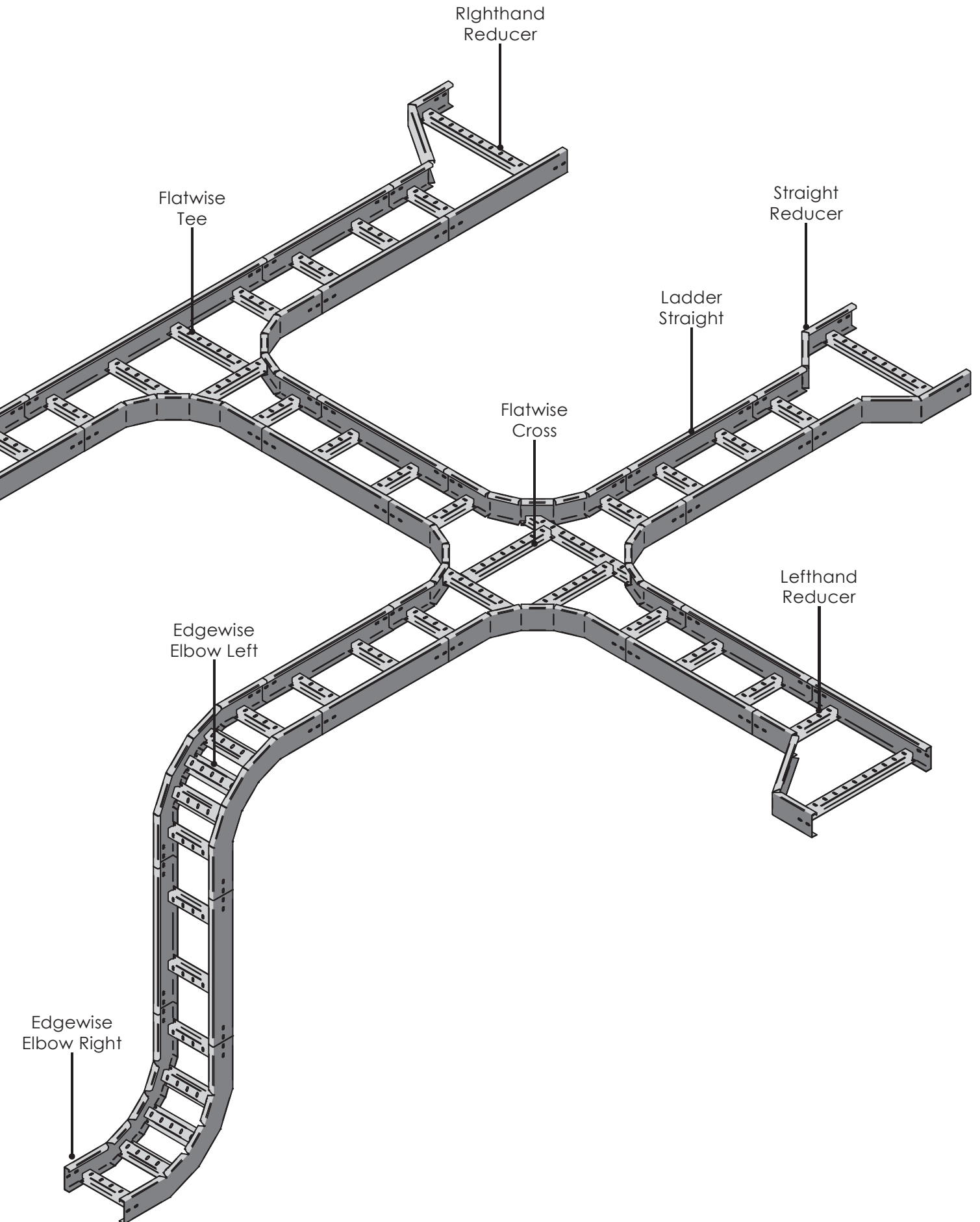

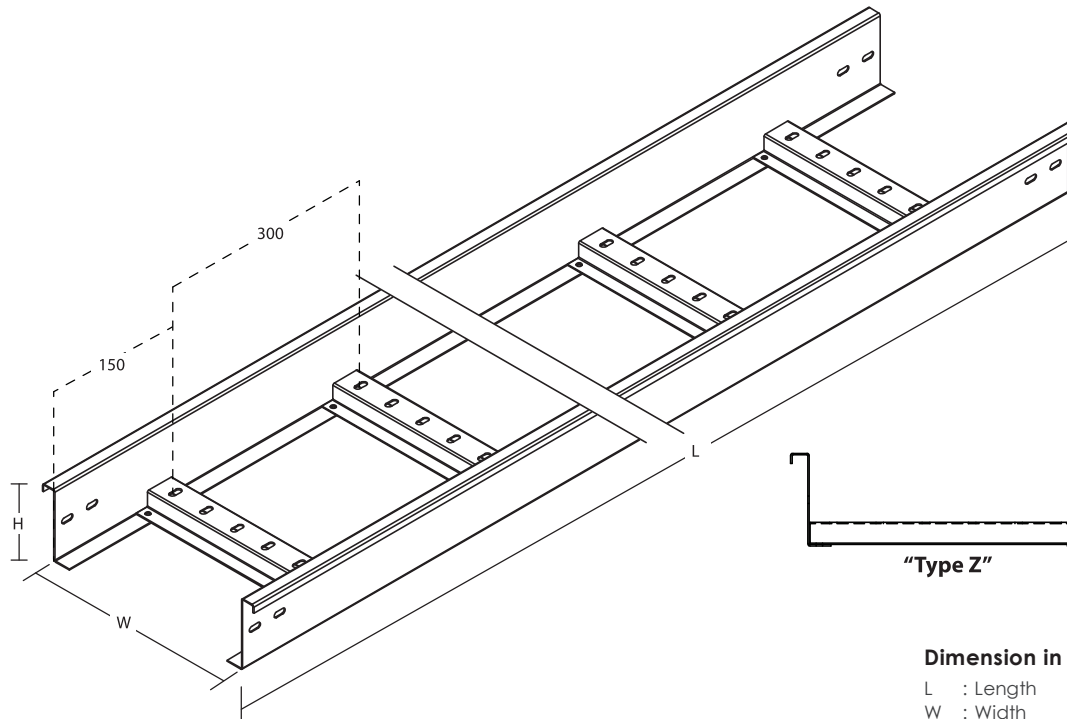

Optional Accessories



Vertical Adjustable Join

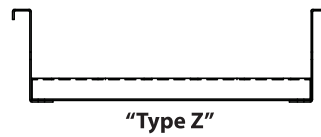

"Type Z"

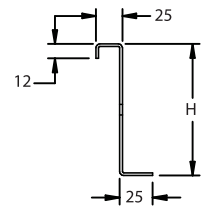

Dimension in Millimeter (mm)

L : Length
W : Width
H : Height

Cable Ladder "Type Z" - Welded (WD)

Model	Nominal Size (mm)		
	Body (LxWxH)	Splice Plate (H)	Thickness
SCL/Z-(150X50)-WD	2438 / 3000 x 150 x 50	49	2
SCL/Z-(200X50)-WD	2438 / 3000 x 200 x 50	49	2
SCL/Z-(250X50)-WD	2438 / 3000 x 250 x 50	49	2
SCL/Z-(300X50)-WD	2438 / 3000 x 300 x 50	49	2
SCL/Z-(150X75)-WD	2438 / 3000 x 150 x 75	74	2
SCL/Z-(200X75)-WD	2438 / 3000 x 200 x 75	74	2
SCL/Z-(250X75)-WD	2438 / 3000 x 250 x 75	74	2
SCL/Z-(300X75)-WD	2438 / 3000 x 300 x 75	74	2
SCL/Z-(450X75)-WD	2438 / 3000 x 450 x 75	74	2
SCL/Z-(600X75)-WD	2438 / 3000 x 600 x 75	74	2
SCL/Z-(900X75)-WD	2438 / 3000 x 900 x 75	74	2
SCL/Z-(150X100)-WD	2438 / 3000 x 150 x 100	99	2
SCL/Z-(200X100)-WD	2438 / 3000 x 200 x 100	99	2
SCL/Z-(250X100)-WD	2438 / 3000 x 250 x 100	99	2
SCL/Z-(300X100)-WD	2438 / 3000 x 300 x 100	99	2
SCL/Z-(400X100)-WD	2438 / 3000 x 400 x 100	99	2
SCL/Z-(450X100)-WD	2438 / 3000 x 450 x 100	99	2
SCL/Z-(500X100)-WD	2438 / 3000 x 500 x 100	99	2
SCL/Z-(600X100)-WD	2438 / 3000 x 600 x 100	99	2
SCL/Z-(750X100)-WD	2438 / 3000 x 750 x 100	99	2
SCL/Z-(900X100)-WD	2438 / 3000 x 900 x 100	99	2
SCL/Z-(1000X100)-WD	2438 / 3000 x 1000 x 100	99	2
SCL/Z-(200X125)-WD	2438 / 3000 x 200 x 125	124	2
SCL/Z-(250X125)-WD	2438 / 3000 x 250 x 125	124	2
SCL/Z-(300X125)-WD	2438 / 3000 x 300 x 125	124	2
SCL/Z-(400X125)-WD	2438 / 3000 x 400 x 125	124	2
SCL/Z-(450X125)-WD	2438 / 3000 x 450 x 125	124	2
SCL/Z-(500X125)-WD	2438 / 3000 x 500 x 125	124	2
SCL/Z-(600X125)-WD	2438 / 3000 x 600 x 125	124	2
SCL/Z-(750X125)-WD	2438 / 3000 x 750 x 125	124	2
SCL/Z-(900X125)-WD	2438 / 3000 x 900 x 125	124	2
SCL/Z-(1000X125)-WD	2438 / 3000 x 1000 x 125	124	2
SCL/Z-(200X150)-WD	2438 / 3000 x 200 x 150	149	2
SCL/Z-(250X150)-WD	2438 / 3000 x 250 x 150	149	2
SCL/Z-(300X150)-WD	2438 / 3000 x 300 x 150	149	2
SCL/Z-(400X150)-WD	2438 / 3000 x 400 x 150	149	2
SCL/Z-(450X150)-WD	2438 / 3000 x 450 x 150	149	2
SCL/Z-(500X150)-WD	2438 / 3000 x 500 x 150	149	2
SCL/Z-(600X150)-WD	2438 / 3000 x 600 x 150	149	2
SCL/Z-(750X150)-WD	2438 / 3000 x 750 x 150	149	2
SCL/Z-(900X150)-WD	2438 / 3000 x 900 x 150	149	2
SCL/Z-(1000X150)-WD	2438 / 3000 x 1000 x 150	149	2

**Specification subject to change without prior notice.
***Thickness Tolerance with + - 10%

*For order information, please refer page 63.

Cable Ladder System

Cable Ladder Straight "Type Z" (Welded / Knock Down)

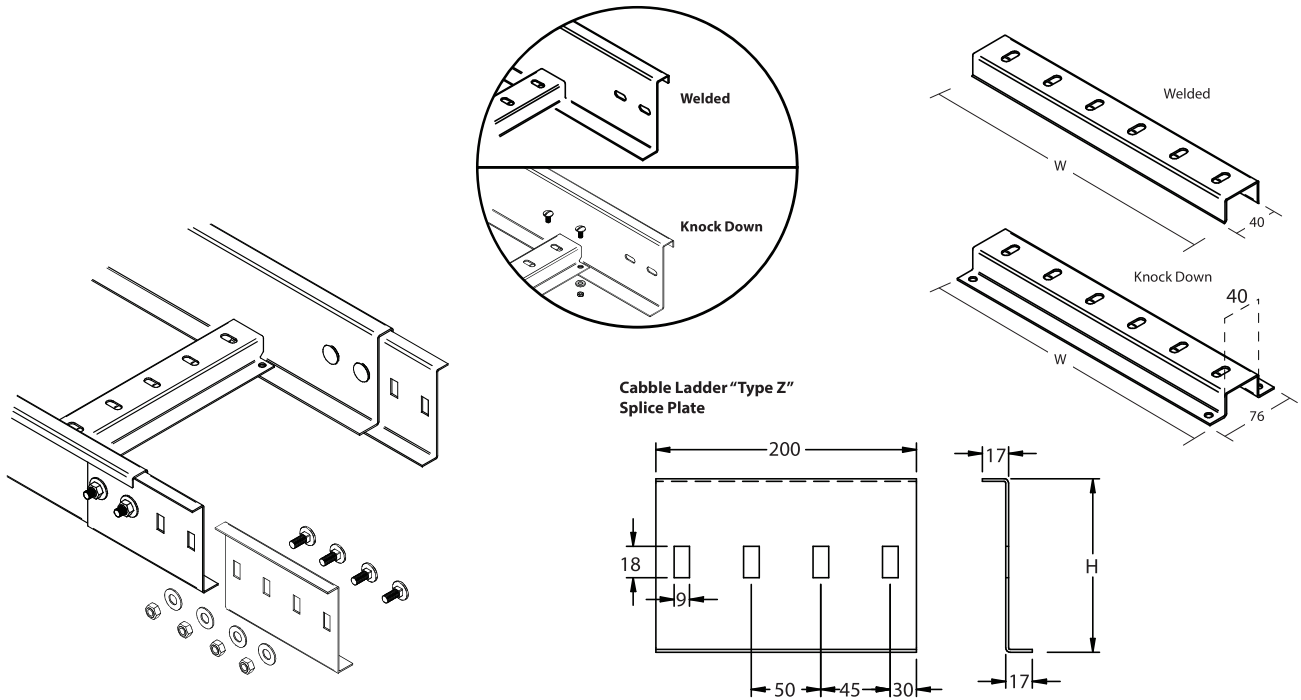

Cable Ladder "Type Z" - Knock Down (KD)

Model	Nominal Size (mm)		
	Body (LxWxH)	Splice Plate (H)	Thickness
SCL/Z-(150X50)-KD	2438 / 3000 x 150 x 50	49	2
SCL/Z-(200X50)-KD	2438 / 3000 x 200 x 50	49	2
SCL/Z-(250X50)-KD	2438 / 3000 x 250 x 50	49	2
SCL/Z-(300X50)-KD	2438 / 3000 x 300 x 50	49	2
SCL/Z-(150X75)-KD	2438 / 3000 x 150 x 75	74	2
SCL/Z-(200X75)-KD	2438 / 3000 x 200 x 75	74	2
SCL/Z-(250X75)-KD	2438 / 3000 x 250 x 75	74	2
SCL/Z-(300X75)-KD	2438 / 3000 x 300 x 75	74	2
SCL/Z-(450X75)-KD	2438 / 3000 x 450 x 75	74	2
SCL/Z-(600X75)-KD	2438 / 3000 x 600 x 75	74	2
SCL/Z-(900X75)-KD	2438 / 3000 x 900 x 75	74	2
SCL/Z-(150X100)-KD	2438 / 3000 x 150 x 100	99	2
SCL/Z-(200X100)-KD	2438 / 3000 x 200 x 100	99	2
SCL/Z-(250X100)-KD	2438 / 3000 x 250 x 100	99	2
SCL/Z-(300X100)-KD	2438 / 3000 x 300 x 100	99	2
SCL/Z-(400X100)-KD	2438 / 3000 x 400 x 100	99	2
SCL/Z-(450X100)-KD	2438 / 3000 x 450 x 100	99	2
SCL/Z-(500X100)-KD	2438 / 3000 x 500 x 100	99	2
SCL/Z-(600X100)-KD	2438 / 3000 x 600 x 100	99	2
SCL/Z-(750X100)-KD	2438 / 3000 x 750 x 100	99	2
SCL/Z-(900X100)-KD	2438 / 3000 x 900 x 100	99	2
SCL/Z-(1000X100)-KD	2438 / 3000 x 1000 x 100	99	2
SCL/Z-(200X125)-KD	2438 / 3000 x 200 x 125	124	2
SCL/Z-(250X125)-KD	2438 / 3000 x 250 x 125	124	2
SCL/Z-(300X125)-KD	2438 / 3000 x 300 x 125	124	2
SCL/Z-(400X125)-KD	2438 / 3000 x 400 x 125	124	2
SCL/Z-(450X125)-KD	2438 / 3000 x 450 x 125	124	2
SCL/Z-(500X125)-KD	2438 / 3000 x 500 x 125	124	2
SCL/Z-(600X125)-KD	2438 / 3000 x 600 x 125	124	2
SCL/Z-(750X125)-KD	2438 / 3000 x 750 x 125	124	2
SCL/Z-(900X125)-KD	2438 / 3000 x 900 x 125	124	2
SCL/Z-(1000X125)-KD	2438 / 3000 x 1000 x 125	124	2
SCL/Z-(200X150)-KD	2438 / 3000 x 200 x 150	149	2
SCL/Z-(250X150)-KD	2438 / 3000 x 250 x 150	149	2
SCL/Z-(300X150)-KD	2438 / 3000 x 300 x 150	149	2
SCL/Z-(400X150)-KD	2438 / 3000 x 400 x 150	149	2
SCL/Z-(450X150)-KD	2438 / 3000 x 450 x 150	149	2
SCL/Z-(500X150)-KD	2438 / 3000 x 500 x 150	149	2
SCL/Z-(600X150)-KD	2438 / 3000 x 600 x 150	149	2
SCL/Z-(750X150)-KD	2438 / 3000 x 750 x 150	149	2
SCL/Z-(900X150)-KD	2438 / 3000 x 900 x 150	149	2
SCL/Z-(1000X150)-KD	2438 / 3000 x 1000 x 150	149	2

**Specification subject to change without prior notice.
 ***Thickness Tolerance with + - 10%

*For order information, please refer page 63.

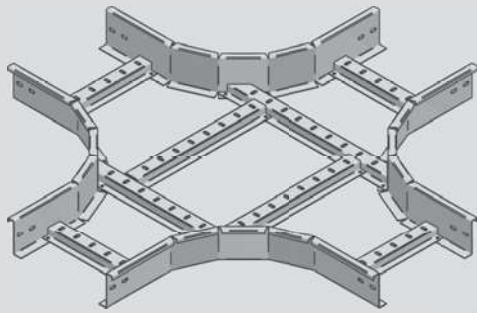

◀ **Flatwise Equal/Unequal Cross**

SCL/Z/WD AC-1
SCL/Z/KD AC-1

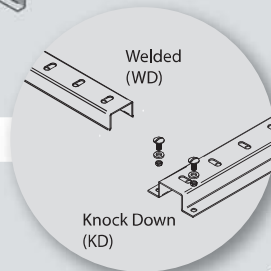

Flatwise Equal/Unequal Tee ▶

SCL/Z/WD AC-2
SCL/Z/KD AC-2

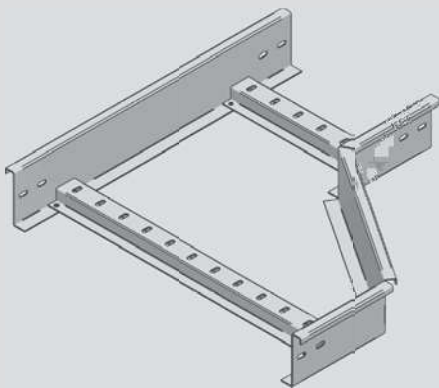
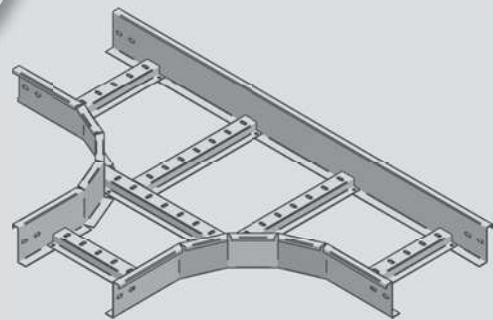

◀ **Righthand Reducer**

SCL/Z/WD AC-3
SCL/Z/KD AC-3

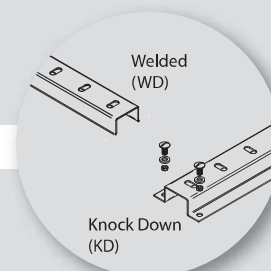

Lefthand Reducer ▶

SCL/Z/WD AC-4
SCL/Z/KD AC-4

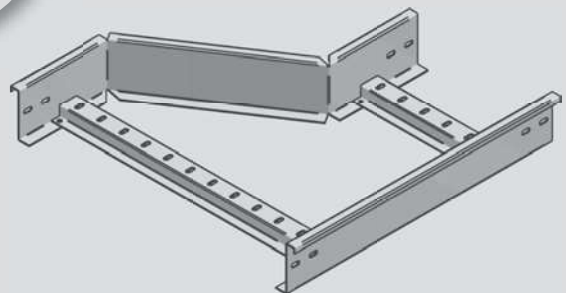

**Other design and sizes are available upon request.

"Type Z" - WD/KD 

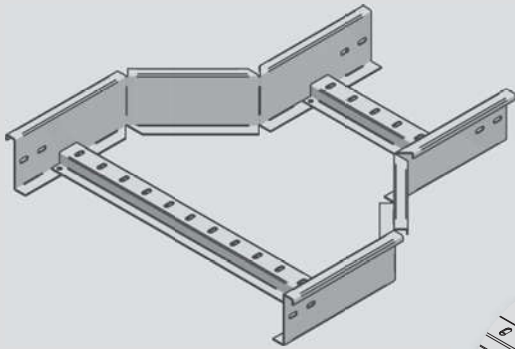

◀ **Straight Reducer**
SCL/Z/WD AC-5
SCL/Z/KD AC-5

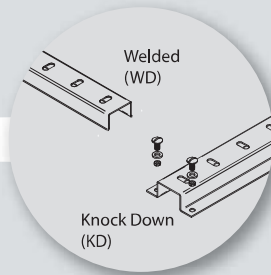

Flatwise Elbow ▶
SCL/Z/WD AC-6
SCL/Z/KD AC-6

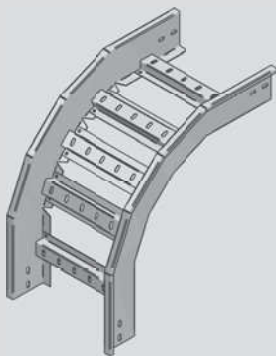
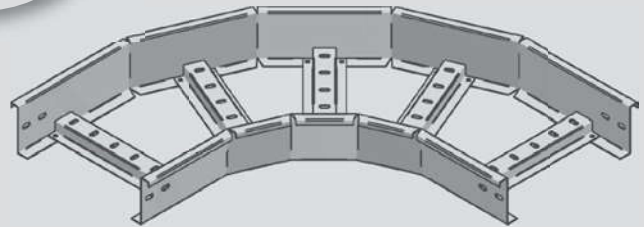

◀ **Edgewise Elbow Left**
SCL/Z/WD AC-7
SCL/Z/KD AC-7

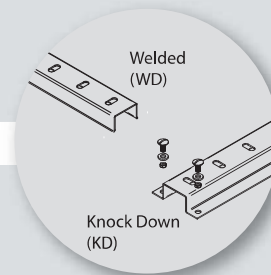

Edgewise Elbow Right ▶
SCL/Z/WD AC-8
SCL/Z/KD AC-8

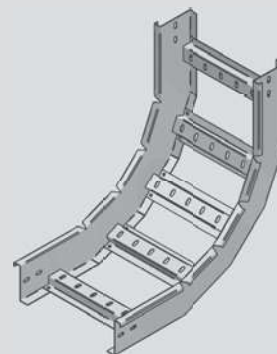

**Other design and sizes are available upon request.

"Type Z" - WD/KD

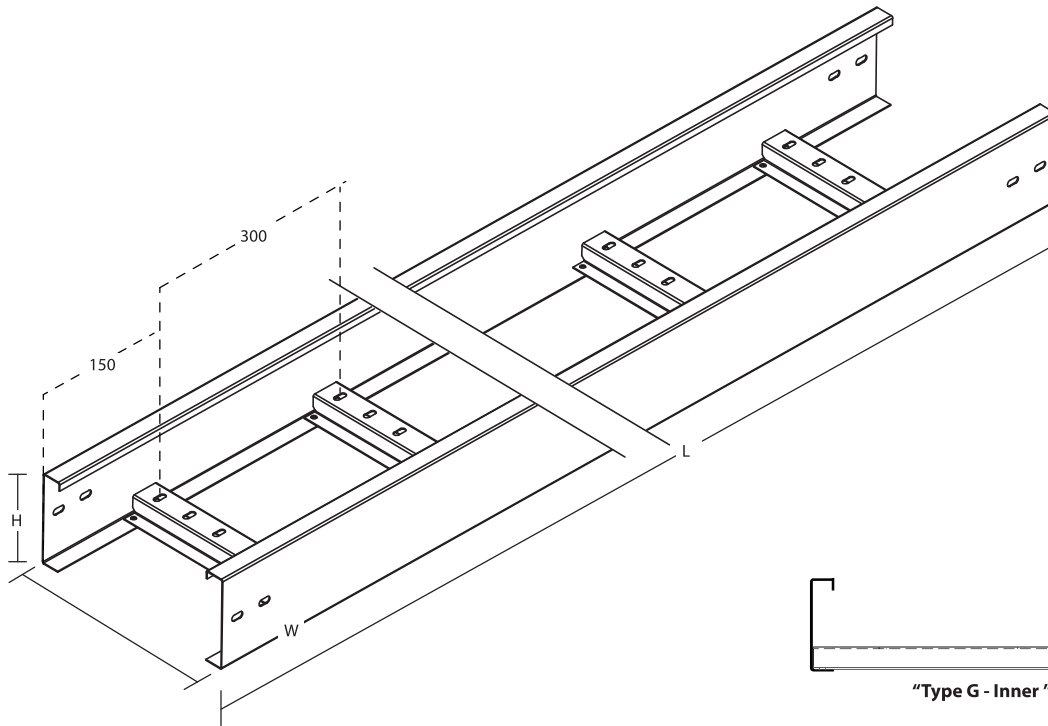

Optional Accessories



Vertical Adjustable Join



"Type G - Inner"

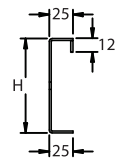

Cable Ladder "Type G - Inner" - Welded (WD)

Model	Nominal Size (mm)		
	Body (LxWxH)	Splice Plate (H)	Thickness
SCL/G/I-(150X50)-WD	2438 / 3000 x 150 x 50	45	2
SCL/G/I-(200X50)-WD	2438 / 3000 x 200 x 50	45	2
SCL/G/I-(250X50)-WD	2438 / 3000 x 250 x 50	45	2
SCL/G/I-(300X50)-WD	2438 / 3000 x 300 x 50	45	2
SCL/G/I-(150X75)-WD	2438 / 3000 x 150 x 75	70	2
SCL/G/I-(200X75)-WD	2438 / 3000 x 200 x 75	70	2
SCL/G/I-(250X75)-WD	2438 / 3000 x 250 x 75	70	2
SCL/G/I-(300X75)-WD	2438 / 3000 x 300 x 75	70	2
SCL/G/I-(450X75)-WD	2438 / 3000 x 450 x 75	70	2
SCL/G/I-(600X75)-WD	2438 / 3000 x 600 x 75	70	2
SCL/G/I-(900X75)-WD	2438 / 3000 x 900 x 75	70	2
SCL/G/I-(150X100)-WD	2438 / 3000 x 150 x 100	95	2
SCL/G/I-(200X100)-WD	2438 / 3000 x 200 x 100	95	2
SCL/G/I-(250X100)-WD	2438 / 3000 x 250 x 100	95	2
SCL/G/I-(300X100)-WD	2438 / 3000 x 300 x 100	95	2
SCL/G/I-(400X100)-WD	2438 / 3000 x 400 x 100	95	2
SCL/G/I-(450X100)-WD	2438 / 3000 x 450 x 100	95	2
SCL/G/I-(500X100)-WD	2438 / 3000 x 500 x 100	95	2
SCL/G/I-(600X100)-WD	2438 / 3000 x 600 x 100	95	2
SCL/G/I-(750X100)-WD	2438 / 3000 x 750 x 100	95	2
SCL/G/I-(900X100)-WD	2438 / 3000 x 900 x 100	95	2
SCL/G/I-(1000X100)-WD	2438 / 3000 x 1000 x 100	95	2
SCL/G/I-(200X125)-WD	2438 / 3000 x 200 x 125	120	2
SCL/G/I-(250X125)-WD	2438 / 3000 x 250 x 125	120	2
SCL/G/I-(300X125)-WD	2438 / 3000 x 300 x 125	120	2
SCL/G/I-(400X125)-WD	2438 / 3000 x 400 x 125	120	2
SCL/G/I-(450X125)-WD	2438 / 3000 x 450 x 125	120	2
SCL/G/I-(500X125)-WD	2438 / 3000 x 500 x 125	120	2
SCL/G/I-(600X125)-WD	2438 / 3000 x 600 x 125	120	2
SCL/G/I-(750X125)-WD	2438 / 3000 x 750 x 125	120	2
SCL/G/I-(900X125)-WD	2438 / 3000 x 900 x 125	120	2
SCL/G/I-(1000X125)-WD	2438 / 3000 x 1000 x 125	120	2
SCL/G/I-(200X150)-WD	2438 / 3000 x 200 x 150	145	2
SCL/G/I-(250X150)-WD	2438 / 3000 x 250 x 150	145	2
SCL/G/I-(300X150)-WD	2438 / 3000 x 300 x 150	145	2
SCL/G/I-(400X150)-WD	2438 / 3000 x 400 x 150	145	2
SCL/G/I-(450X150)-WD	2438 / 3000 x 450 x 150	145	2
SCL/G/I-(500X150)-WD	2438 / 3000 x 500 x 150	145	2
SCL/G/I-(600X150)-WD	2438 / 3000 x 600 x 150	145	2
SCL/G/I-(750X150)-WD	2438 / 3000 x 750 x 150	145	2
SCL/G/I-(900X150)-WD	2438 / 3000 x 900 x 150	145	2
SCL/G/I-(1000X150)-WD	2438 / 3000 x 1000 x 150	145	2

**Specification subject to change without prior notice.
 ***Thickness Tolerance with + - 10%

*For order information, please refer page 63.

Cable Ladder System

Cable Ladder Straight "Type G - Inner" (Welded / Knock Down)

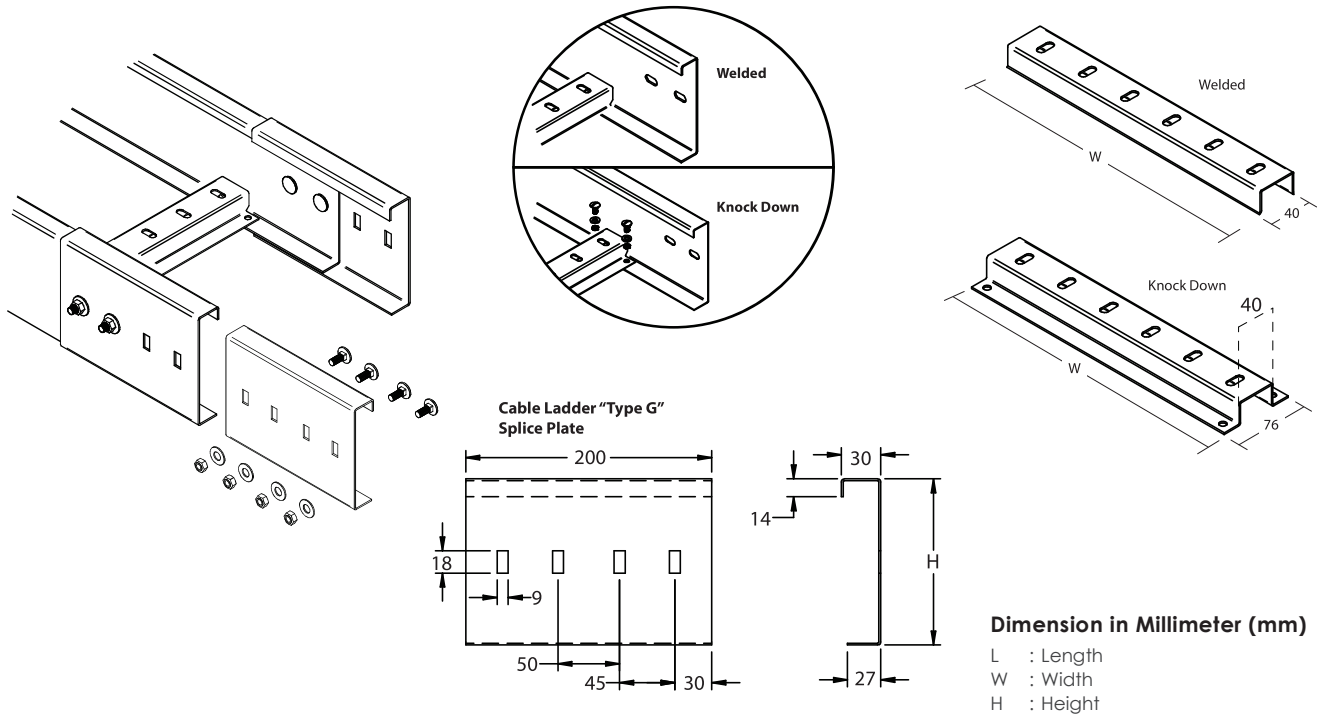

Cable Ladder "Type G - Inner" - Knock Down (KD)

Model	Nominal Size (mm)		
	Body (LxWxH)	Splice Plate (H)	Thickness
SCL/G/I-(150X50)-KD	2438 / 3000 x 150 x 50	45	2
SCL/G/I-(200X50)-KD	2438 / 3000 x 200 x 50	45	2
SCL/G/I-(250X50)-KD	2438 / 3000 x 250 x 50	45	2
SCL/G/I-(300X50)-KD	2438 / 3000 x 300 x 50	45	2
SCL/G/I-(150X75)-KD	2438 / 3000 x 150 x 75	70	2
SCL/G/I-(200X75)-KD	2438 / 3000 x 200 x 75	70	2
SCL/G/I-(250X75)-KD	2438 / 3000 x 250 x 75	70	2
SCL/G/I-(300X75)-KD	2438 / 3000 x 300 x 75	70	2
SCL/G/I-(450X75)-KD	2438 / 3000 x 450 x 75	70	2
SCL/G/I-(600X75)-KD	2438 / 3000 x 600 x 75	70	2
SCL/G/I-(900X75)-KD	2438 / 3000 x 900 x 75	70	2
SCL/G/I-(150X100)-KD	2438 / 3000 x 150 x 100	95	2
SCL/G/I-(200X100)-KD	2438 / 3000 x 200 x 100	95	2
SCL/G/I-(250X100)-KD	2438 / 3000 x 250 x 100	95	2
SCL/G/I-(300X100)-KD	2438 / 3000 x 300 x 100	95	2
SCL/G/I-(400X100)-KD	2438 / 3000 x 400 x 100	95	2
SCL/G/I-(450X100)-KD	2438 / 3000 x 450 x 100	95	2
SCL/G/I-(500X100)-KD	2438 / 3000 x 500 x 100	95	2
SCL/G/I-(600X100)-KD	2438 / 3000 x 600 x 100	95	2
SCL/G/I-(750X100)-KD	2438 / 3000 x 750 x 100	95	2
SCL/G/I-(900X100)-KD	2438 / 3000 x 900 x 100	95	2
SCL/G/I-(1000X100)-KD	2438 / 3000 x 1000 x 100	95	2
SCL/G/I-(200X125)-KD	2438 / 3000 x 200 x 125	120	2
SCL/G/I-(250X125)-KD	2438 / 3000 x 250 x 125	120	2
SCL/G/I-(300X125)-KD	2438 / 3000 x 300 x 125	120	2
SCL/G/I-(400X125)-KD	2438 / 3000 x 400 x 125	120	2
SCL/G/I-(450X125)-KD	2438 / 3000 x 450 x 125	120	2
SCL/G/I-(500X125)-KD	2438 / 3000 x 500 x 125	120	2
SCL/G/I-(600X125)-KD	2438 / 3000 x 600 x 125	120	2
SCL/G/I-(750X125)-KD	2438 / 3000 x 750 x 125	120	2
SCL/G/I-(900X125)-KD	2438 / 3000 x 900 x 125	120	2
SCL/G/I-(1000X125)-KD	2438 / 3000 x 1000 x 125	120	2
SCL/G/I-(200X150)-KD	2438 / 3000 x 200 x 150	145	2
SCL/G/I-(250X150)-KD	2438 / 3000 x 250 x 150	145	2
SCL/G/I-(300X150)-KD	2438 / 3000 x 300 x 150	145	2
SCL/G/I-(400X150)-KD	2438 / 3000 x 400 x 150	145	2
SCL/G/I-(450X150)-KD	2438 / 3000 x 450 x 150	145	2
SCL/G/I-(500X150)-KD	2438 / 3000 x 500 x 150	145	2
SCL/G/I-(600X150)-KD	2438 / 3000 x 600 x 150	145	2
SCL/G/I-(750X150)-KD	2438 / 3000 x 750 x 150	145	2
SCL/G/I-(900X150)-KD	2438 / 3000 x 900 x 150	145	2
SCL/G/I-(1000X150)-KD	2438 / 3000 x 1000 x 150	145	2

**Specification subject to change without prior notice.
 ***Thickness Tolerance with + - 10%

*For order information, please refer page 63.

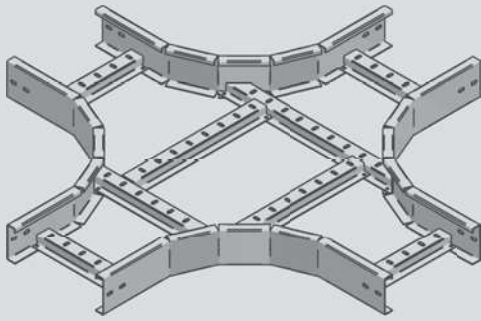

◀ **Flatwise Equal/Unequal Cross**

SCL/G/I/WD AC-1
SCL/G/I/KD AC-1

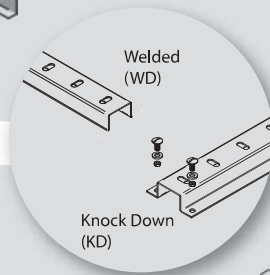

Flatwise Equal/Unequal Tee ▶

SCL/G/I/WD AC-2
SCL/G/I/KD AC-2

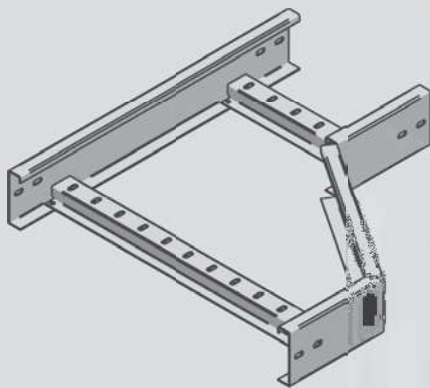
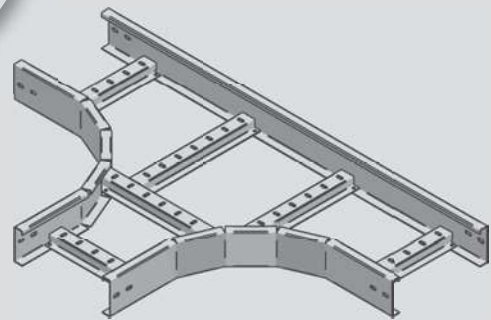

◀ **Righthand Reducer**

SCL/G/I/WD AC-3
SCL/G/I/KD AC-3

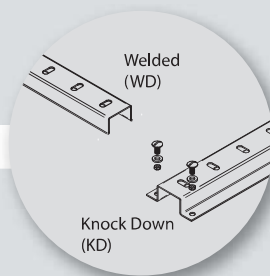

Lefthand Reducer ▶

SCL/G/I/WD AC-4
SCL/G/I/KD AC-4

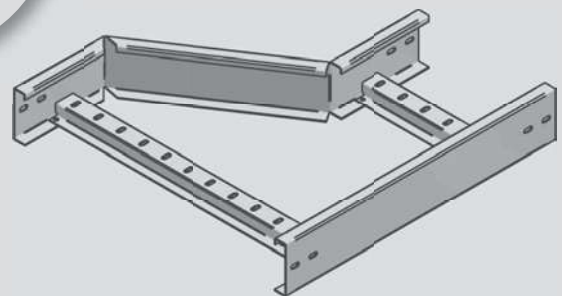

**Other design and sizes are available upon request.

"Type G - Inner" - WD/KD 

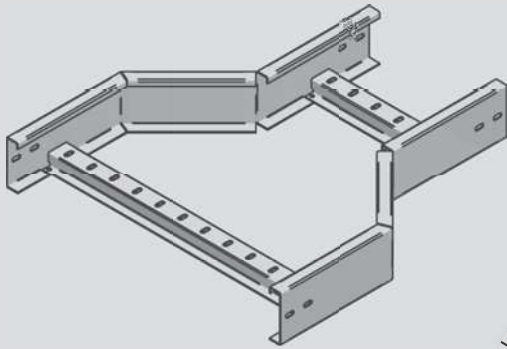

◀ **Straight Reducer**
SCL/G/I/WD AC-5
SCL/G/I/KD AC-5

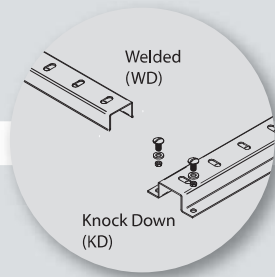

Flatwise Elbow ▶
SCL/G/I/WD AC-6
SCL/G/I/KD AC-6

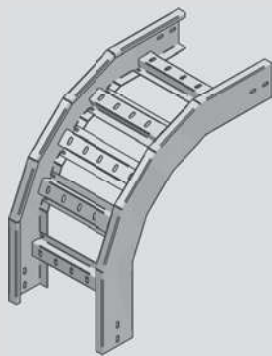
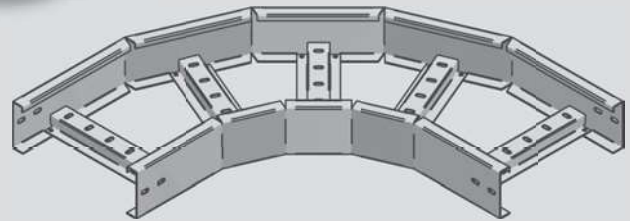

◀ **Edgewise Elbow Left**
SCL/G/I/WD AC-7
SCL/G/I/KD AC-7

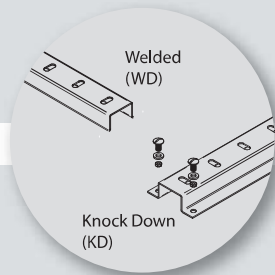

Edgewise Elbow Right ▶
SCL/G/I/WD AC-8
SCL/G/I/KD AC-8

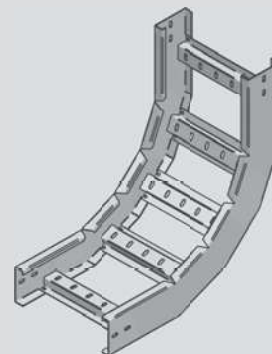

**Other design and sizes are available upon request.

"Type G - Inner" - WD/KD

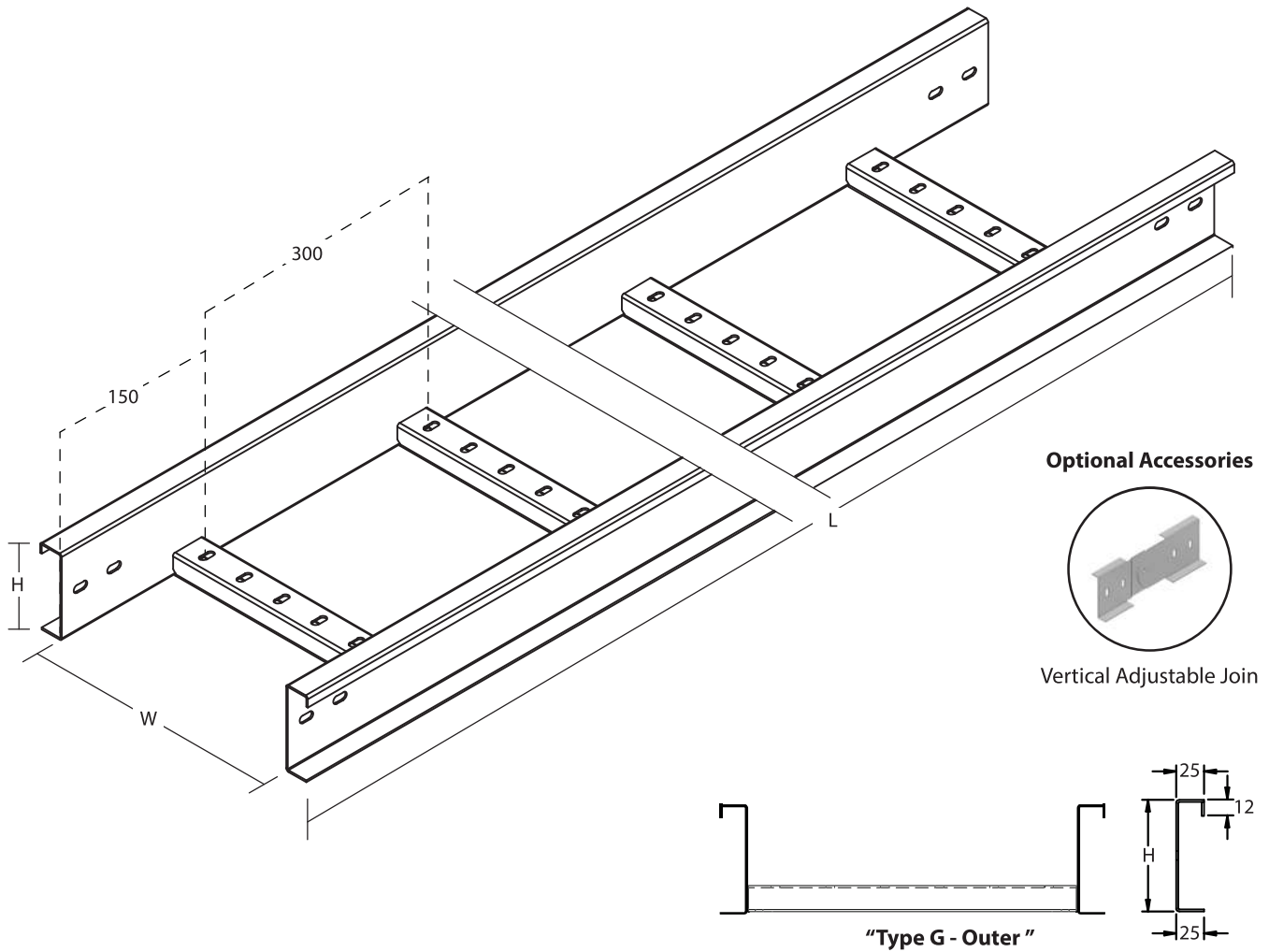

Cable Ladder "Type G - Outer" - Welded (WD)

Model	Nominal Size (mm)		
	Body (LxWxH)	Splice Plate (H)	Thickness
SCL/G/O-(150X50)-WD	2438 / 3000 x 150 x 50	45	2
SCL/G/O-(200X50)-WD	2438 / 3000 x 200 x 50	45	2
SCL/G/O-(250X50)-WD	2438 / 3000 x 250 x 50	45	2
SCL/G/O-(300X50)-WD	2438 / 3000 x 300 x 50	45	2
SCL/G/O-(150X75)-WD	2438 / 3000 x 150 x 75	70	2
SCL/G/O-(200X75)-WD	2438 / 3000 x 200 x 75	70	2
SCL/G/O-(250X75)-WD	2438 / 3000 x 250 x 75	70	2
SCL/G/O-(300X75)-WD	2438 / 3000 x 300 x 75	70	2
SCL/G/O-(450X75)-WD	2438 / 3000 x 450 x 75	70	2
SCL/G/O-(600X75)-WD	2438 / 3000 x 600 x 75	70	2
SCL/G/O-(900X75)-WD	2438 / 3000 x 900 x 75	70	2
SCL/G/O-(150X100)-WD	2438 / 3000 x 150 x 100	95	2
SCL/G/O-(200X100)-WD	2438 / 3000 x 200 x 100	95	2
SCL/G/O-(250X100)-WD	2438 / 3000 x 250 x 100	95	2
SCL/G/O-(300X100)-WD	2438 / 3000 x 300 x 100	95	2
SCL/G/O-(400X100)-WD	2438 / 3000 x 400 x 100	95	2
SCL/G/O-(450X100)-WD	2438 / 3000 x 450 x 100	95	2
SCL/G/O-(500X100)-WD	2438 / 3000 x 500 x 100	95	2
SCL/G/O-(600X100)-WD	2438 / 3000 x 600 x 100	95	2
SCL/G/O-(750X100)-WD	2438 / 3000 x 750 x 100	95	2
SCL/G/O-(900X100)-WD	2438 / 3000 x 900 x 100	95	2

**Specification subject to change without prior notice.
 ***Thickness Tolerance with + - 10%

*For order information, please refer page 63.

Cable Ladder System

Cable Ladder Straight "Type G - Outer" (Welded)

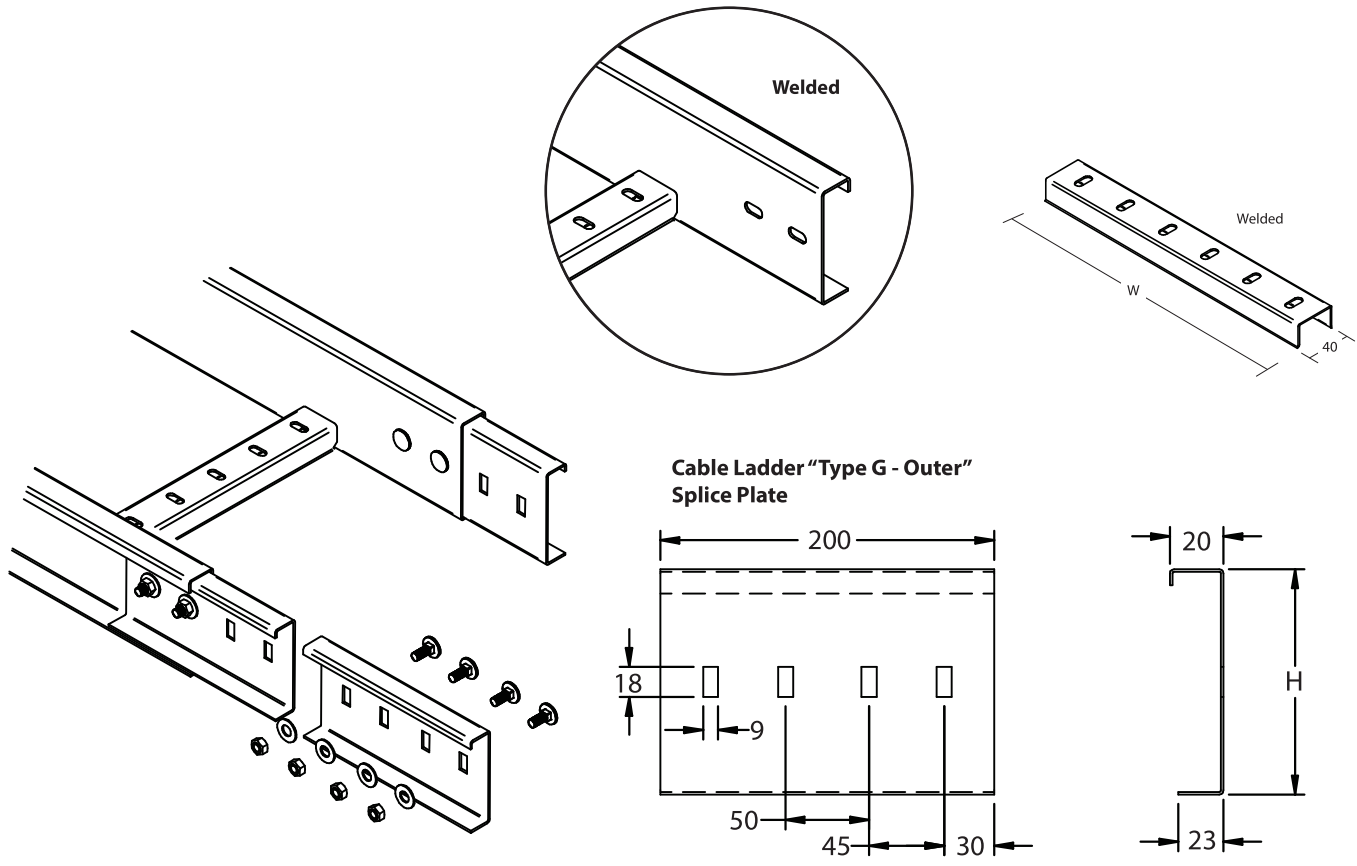

Dimension in Millimeter (mm)

L : Length
W : Width
H : Height

Cable Ladder "Type G - Outer" - Welded (WD)

Model	Nominal Size (mm)		
	Body (LxWxH)	Splice Plate (H)	Thickness
SCL/G/O-(1000X100)-WD	2438 / 3000 x 1000 x 100	95	2
SCL/G/O-(200X125)-WD	2438 / 3000 x 200 x 125	120	2
SCL/G/O-(250X125)-WD	2438 / 3000 x 250 x 125	120	2
SCL/G/O-(300X125)-WD	2438 / 3000 x 300 x 125	120	2
SCL/G/O-(400X125)-WD	2438 / 3000 x 400 x 125	120	2
SCL/G/O-(450X125)-WD	2438 / 3000 x 450 x 125	120	2
SCL/G/O-(500X125)-WD	2438 / 3000 x 500 x 125	120	2
SCL/G/O-(600X125)-WD	2438 / 3000 x 600 x 125	120	2
SCL/G/O-(750X125)-WD	2438 / 3000 x 750 x 125	120	2
SCL/G/O-(900X125)-WD	2438 / 3000 x 900 x 125	120	2
SCL/G/O-(1000X125)-WD	2438 / 3000 x 1000 x 125	120	2
SCL/G/O-(200X150)-WD	2438 / 3000 x 200 x 150	145	2
SCL/G/O-(250X150)-WD	2438 / 3000 x 250 x 150	145	2
SCL/G/O-(300X150)-WD	2438 / 3000 x 300 x 150	145	2
SCL/G/O-(400X150)-WD	2438 / 3000 x 400 x 150	145	2
SCL/G/O-(450X150)-WD	2438 / 3000 x 450 x 150	145	2
SCL/G/O-(500X150)-WD	2438 / 3000 x 500 x 150	145	2
SCL/G/O-(600X150)-WD	2438 / 3000 x 600 x 150	145	2
SCL/G/O-(750X150)-WD	2438 / 3000 x 750 x 150	145	2
SCL/G/O-(900X150)-WD	2438 / 3000 x 900 x 150	145	2
SCL/G/O-(1000X150)-WD	2438 / 3000 x 1000 x 150	145	2

**Specification subject to change without prior notice.
***Thickness Tolerance with + - 10%

*For order information, please refer page 63.

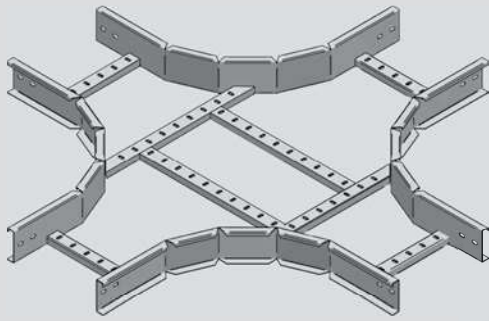

◀ **Flatwise Equal/Unequal Cross**
SCL/G/O/WD AC-1

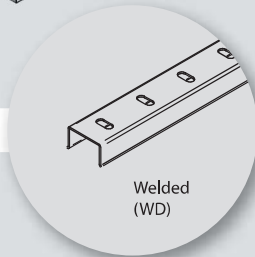

Welded
(WD)

Flatwise Equal/Unequal Tee ▶
SCL/G/O/WD AC-2

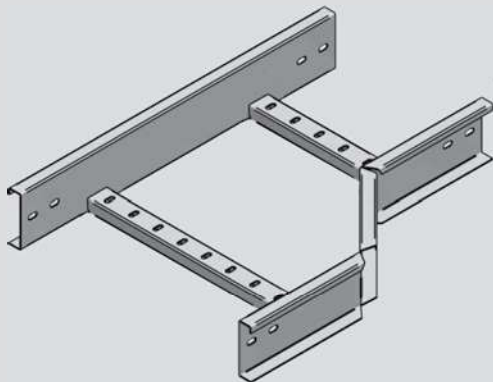
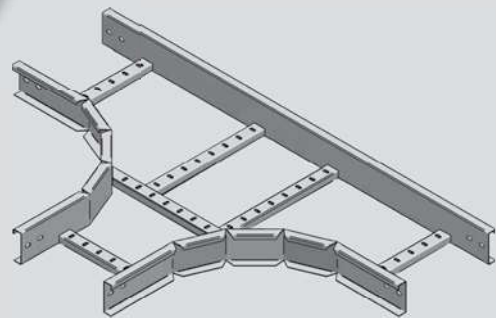

◀ **Righthand Reducer**
SCL/G/O/WD AC-3

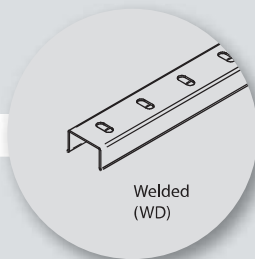

Welded
(WD)

Lefthand Reducer ▶
SCL/G/O/WD AC-4

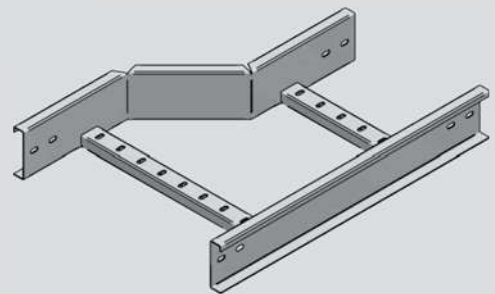

**Other design and sizes are available upon request.

"Type G - Outer" - WD 

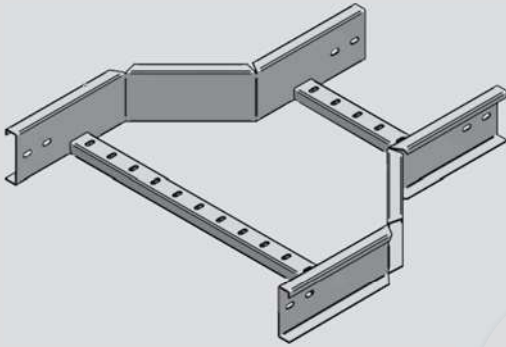

◀ **Straight Reducer**
SCL/G/O/WD AC-5

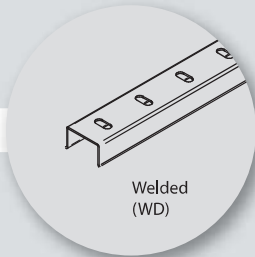

Welded (WD)

Flatwise Elbow ▶
SCL/G/O/WD AC-6

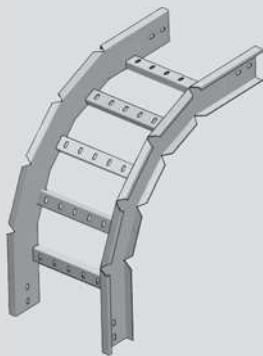
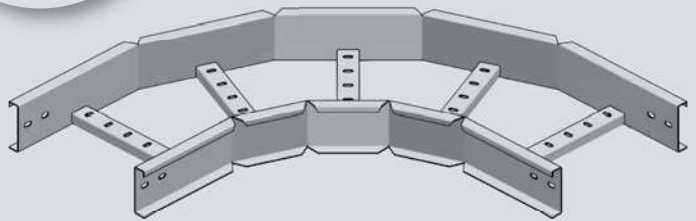

◀ **Edgewise Elbow Left**
SCL/G/O/WD AC-7

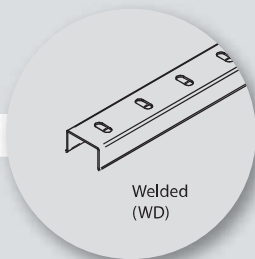

Welded (WD)

Edgewise Elbow Right ▶
SCL/G/O/WD AC-8

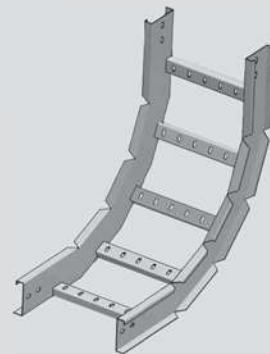

**Other design and sizes are available upon request.

"Type G - Outer" - WD

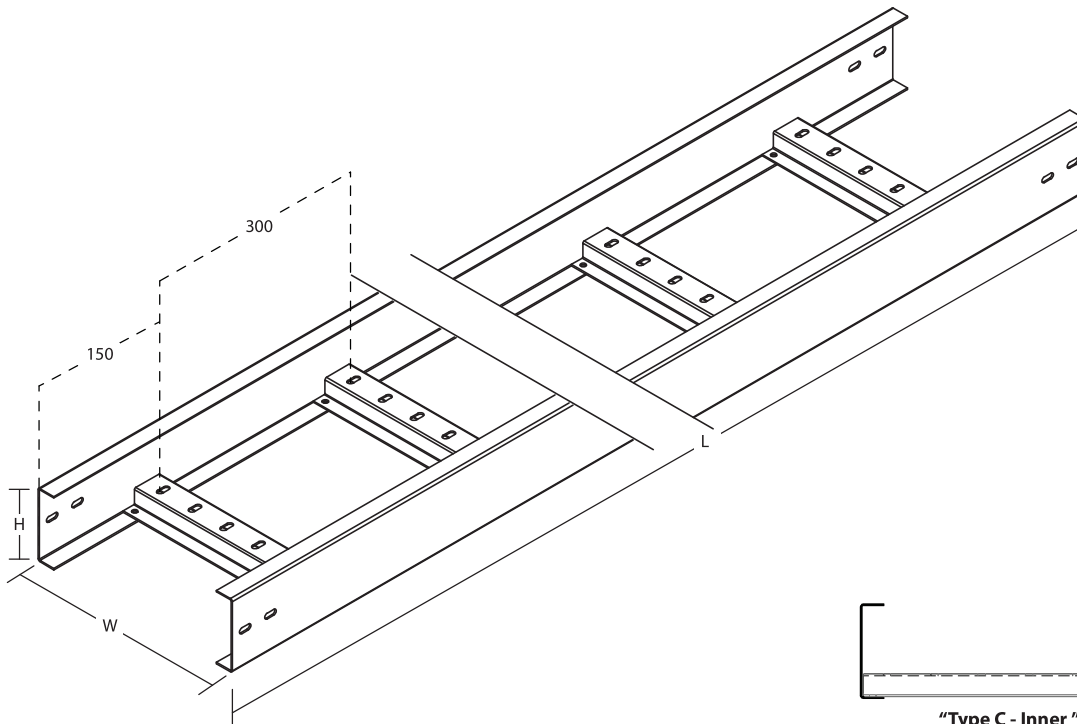

Optional Accessories



Vertical Adjustable Join

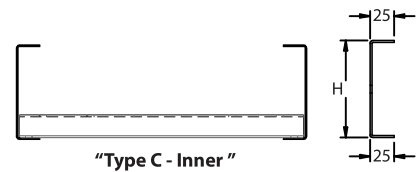

Cable Ladder "Type C - Inner" - Welded (WD)

Model	Nominal Size (mm)		
	Body (LxWxH)	Splice Plate (H)	Thickness
SCL/C/I-(150X50)-WD	2438 / 3000 x 150 x 50	45	2
SCL/C/I-(200X50)-WD	2438 / 3000 x 200 x 50	45	2
SCL/C/I-(250X50)-WD	2438 / 3000 x 250 x 50	45	2
SCL/C/I-(300X50)-WD	2438 / 3000 x 300 x 50	45	2
SCL/C/I-(150X75)-WD	2438 / 3000 x 150 x 75	70	2
SCL/C/I-(200X75)-WD	2438 / 3000 x 200 x 75	70	2
SCL/C/I-(250X75)-WD	2438 / 3000 x 250 x 75	70	2
SCL/C/I-(300X75)-WD	2438 / 3000 x 300 x 75	70	2
SCL/C/I-(450X75)-WD	2438 / 3000 x 450 x 75	70	2
SCL/C/I-(600X75)-WD	2438 / 3000 x 600 x 75	70	2
SCL/C/I-(900X75)-WD	2438 / 3000 x 900 x 75	70	2
SCL/C/I-(150X100)-WD	2438 / 3000 x 150 x 100	95	2
SCL/C/I-(200X100)-WD	2438 / 3000 x 200 x 100	95	2
SCL/C/I-(250X100)-WD	2438 / 3000 x 250 x 100	95	2
SCL/C/I-(300X100)-WD	2438 / 3000 x 300 x 100	95	2
SCL/C/I-(400X100)-WD	2438 / 3000 x 400 x 100	95	2
SCL/C/I-(450X100)-WD	2438 / 3000 x 450 x 100	95	2
SCL/C/I-(500X100)-WD	2438 / 3000 x 500 x 100	95	2
SCL/C/I-(600X100)-WD	2438 / 3000 x 600 x 100	95	2
SCL/C/I-(750X100)-WD	2438 / 3000 x 750 x 100	95	2
SCL/C/I-(900X100)-WD	2438 / 3000 x 900 x 100	95	2
SCL/C/I-(1000X100)-WD	2438 / 3000 x 1000 x 100	95	2
SCL/C/I-(200X125)-WD	2438 / 3000 x 200 x 125	120	2
SCL/C/I-(250X125)-WD	2438 / 3000 x 250 x 125	120	2
SCL/C/I-(300X125)-WD	2438 / 3000 x 300 x 125	120	2
SCL/C/I-(400X125)-WD	2438 / 3000 x 400 x 125	120	2
SCL/C/I-(450X125)-WD	2438 / 3000 x 450 x 125	120	2
SCL/C/I-(500X125)-WD	2438 / 3000 x 500 x 125	120	2
SCL/C/I-(600X125)-WD	2438 / 3000 x 600 x 125	120	2
SCL/C/I-(750X125)-WD	2438 / 3000 x 750 x 125	120	2
SCL/C/I-(900X125)-WD	2438 / 3000 x 900 x 125	120	2
SCL/C/I-(1000X125)-WD	2438 / 3000 x 1000 x 125	120	2
SCL/C/I-(200X150)-WD	2438 / 3000 x 200 x 150	145	2
SCL/C/I-(250X150)-WD	2438 / 3000 x 250 x 150	145	2
SCL/C/I-(300X150)-WD	2438 / 3000 x 300 x 150	145	2
SCL/C/I-(400X150)-WD	2438 / 3000 x 400 x 150	145	2
SCL/C/I-(450X150)-WD	2438 / 3000 x 450 x 150	145	2
SCL/C/I-(500X150)-WD	2438 / 3000 x 500 x 150	145	2
SCL/C/I-(600X150)-WD	2438 / 3000 x 600 x 150	145	2
SCL/C/I-(750X150)-WD	2438 / 3000 x 750 x 150	145	2
SCL/C/I-(900X150)-WD	2438 / 3000 x 900 x 150	145	2
SCL/C/I-(1000X150)-WD	2438 / 3000 x 1000 x 150	145	2

**Specification subject to change without prior notice.
 ***Thickness Tolerance with + - 10%

*For order information, please refer page 63.

Cable Ladder System

Cable Ladder Straight "Type C - Inner" (Welded / Knock Down)

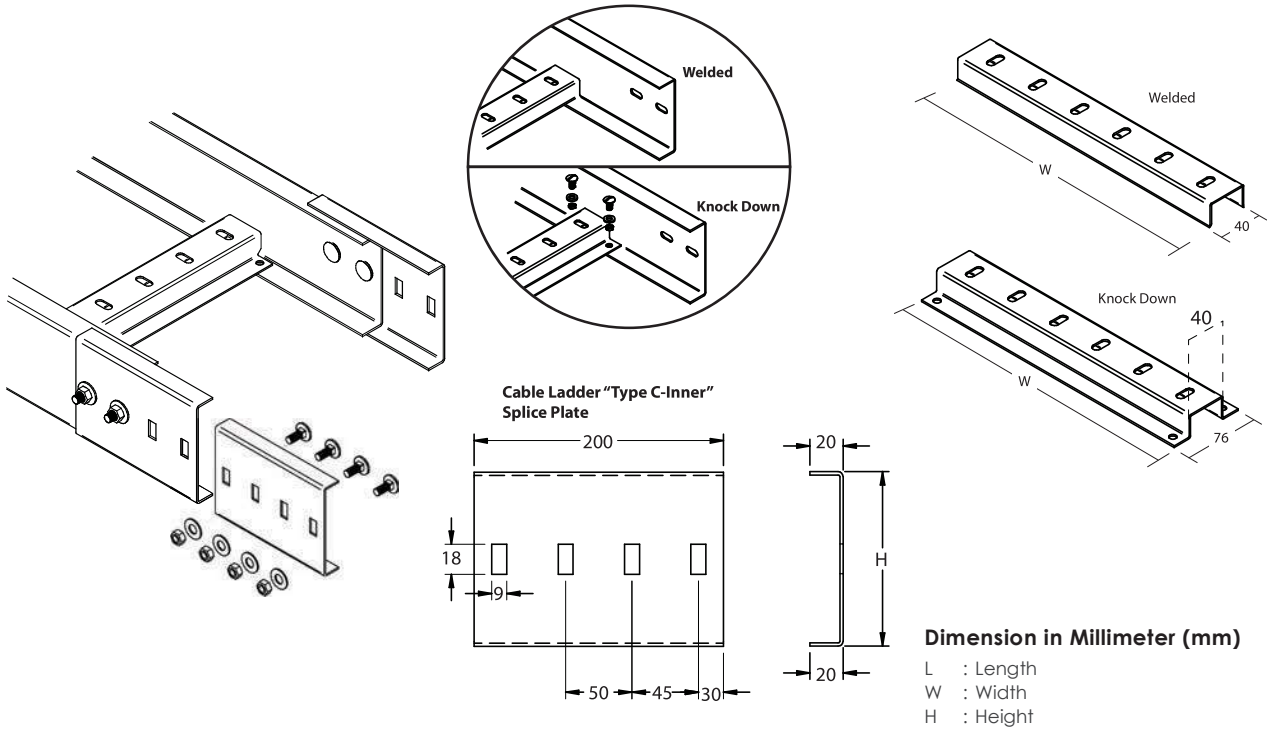

Cable Ladder "Type C - Inner" - Knock Down (KD)

Model	Nominal Size (mm)		
	Body (LxWxH)	Splice Plate (H)	Thickness
SCL/C/I-(150X50)-KD	2438 / 3000 x 150 x 50	45	2
SCL/C/I-(200X50)-KD	2438 / 3000 x 200 x 50	45	2
SCL/C/I-(250X50)-KD	2438 / 3000 x 250 x 50	45	2
SCL/C/I-(300X50)-KD	2438 / 3000 x 300 x 50	45	2
SCL/C/I-(150X75)-KD	2438 / 3000 x 150 x 75	70	2
SCL/C/I-(200X75)-KD	2438 / 3000 x 200 x 75	70	2
SCL/C/I-(250X75)-KD	2438 / 3000 x 250 x 75	70	2
SCL/C/I-(300X75)-KD	2438 / 3000 x 300 x 75	70	2
SCL/C/I-(450X75)-KD	2438 / 3000 x 450 x 75	70	2
SCL/C/I-(600X75)-KD	2438 / 3000 x 600 x 75	70	2
SCL/C/I-(900X75)-KD	2438 / 3000 x 900 x 75	70	2
SCL/C/I-(150X100)-KD	2438 / 3000 x 150 x 100	95	2
SCL/C/I-(200X100)-KD	2438 / 3000 x 200 x 100	95	2
SCL/C/I-(250X100)-KD	2438 / 3000 x 250 x 100	95	2
SCL/C/I-(300X100)-KD	2438 / 3000 x 300 x 100	95	2
SCL/C/I-(400X100)-KD	2438 / 3000 x 400 x 100	95	2
SCL/C/I-(450X100)-KD	2438 / 3000 x 450 x 100	95	2
SCL/C/I-(500X100)-KD	2438 / 3000 x 500 x 100	95	2
SCL/C/I-(600X100)-KD	2438 / 3000 x 600 x 100	95	2
SCL/C/I-(750X100)-KD	2438 / 3000 x 750 x 100	95	2
SCL/C/I-(900X100)-KD	2438 / 3000 x 900 x 100	95	2
SCL/C/I-(1000X100)-KD	2438 / 3000 x 1000 x 100	95	2
SCL/C/I-(200X125)-KD	2438 / 3000 x 200 x 125	120	2
SCL/C/I-(250X125)-KD	2438 / 3000 x 250 x 125	120	2
SCL/C/I-(300X125)-KD	2438 / 3000 x 300 x 125	120	2
SCL/C/I-(400X125)-KD	2438 / 3000 x 400 x 125	120	2
SCL/C/I-(450X125)-KD	2438 / 3000 x 450 x 125	120	2
SCL/C/I-(500X125)-KD	2438 / 3000 x 500 x 125	120	2
SCL/C/I-(600X125)-KD	2438 / 3000 x 600 x 125	120	2
SCL/C/I-(750X125)-KD	2438 / 3000 x 750 x 125	120	2
SCL/C/I-(900X125)-KD	2438 / 3000 x 900 x 125	120	2
SCL/C/I-(1000X125)-KD	2438 / 3000 x 1000 x 125	120	2
SCL/C/I-(200X150)-KD	2438 / 3000 x 200 x 150	145	2
SCL/C/I-(250X150)-KD	2438 / 3000 x 250 x 150	145	2
SCL/C/I-(300X150)-KD	2438 / 3000 x 300 x 150	145	2
SCL/C/I-(400X150)-KD	2438 / 3000 x 400 x 150	145	2
SCL/C/I-(450X150)-KD	2438 / 3000 x 450 x 150	145	2
SCL/C/I-(500X150)-KD	2438 / 3000 x 500 x 150	145	2
SCL/C/I-(600X150)-KD	2438 / 3000 x 600 x 150	145	2
SCL/C/I-(750X150)-KD	2438 / 3000 x 750 x 150	145	2
SCL/C/I-(900X150)-KD	2438 / 3000 x 900 x 150	145	2
SCL/C/I-(1000X150)-KD	2438 / 3000 x 1000 x 150	145	2

**Specification subject to change without prior notice.
 ***Thickness Tolerance with + - 10%

*For order information, please refer page 63.

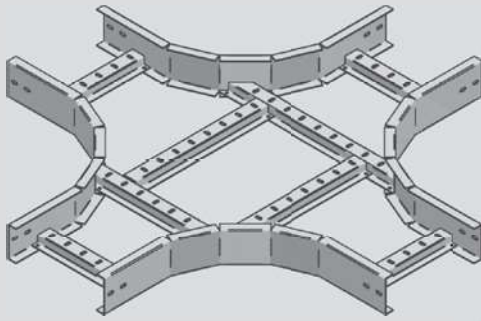

◀ **Flatwise Equal/Unequal Cross**
SCL/C/I/WD AC-1
SCL/C/I/KD AC-1

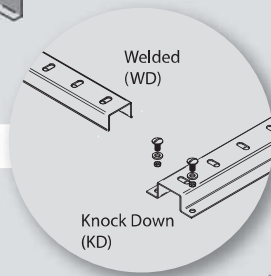

Flatwise Equal/Unequal Tee ▶
SCL/C/I/WD AC-2
SCL/C/I/KD AC-2

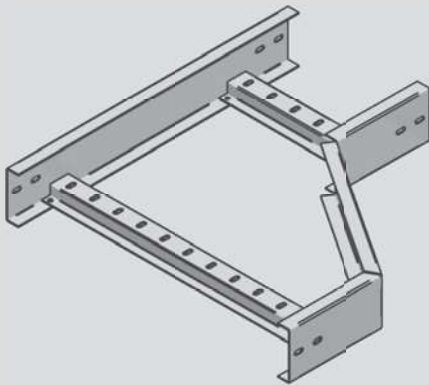
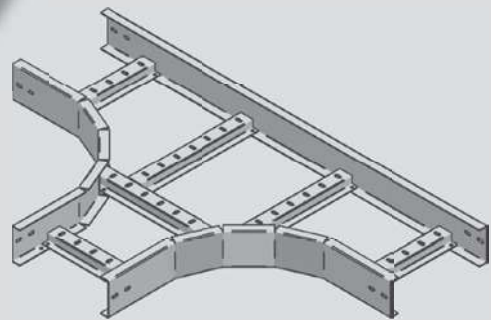

◀ **Righthand Reducer**
SCL/C/I/WD AC-3
SCL/C/I/KD AC-3

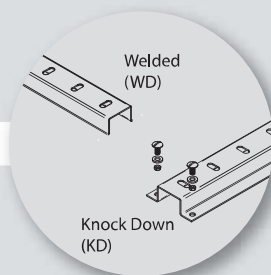

Lefthand Reducer ▶
SCL/C/I/WD AC-4
SCL/C/I/KD AC-4

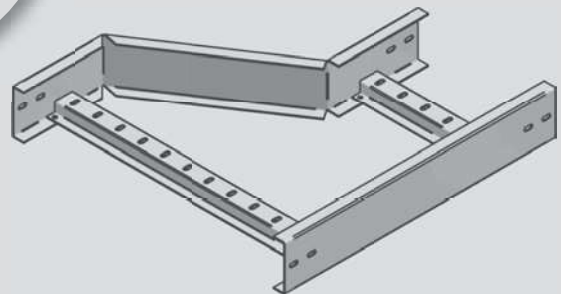

**Other design and sizes are available upon request.

"Type C - Inner" - WD/KD 

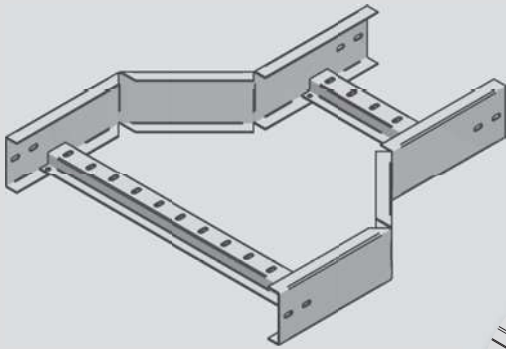

◀ **Straight Reducer**
SCL/C/I/WD AC-5
SCL/C/I/KD AC-5

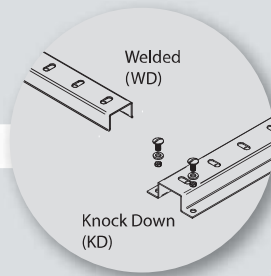

Flatwise Elbow ▶
SCL/C/I/WD AC-6
SCL/C/I/KD AC-6

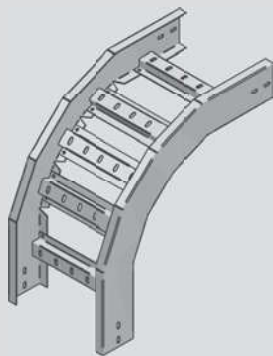
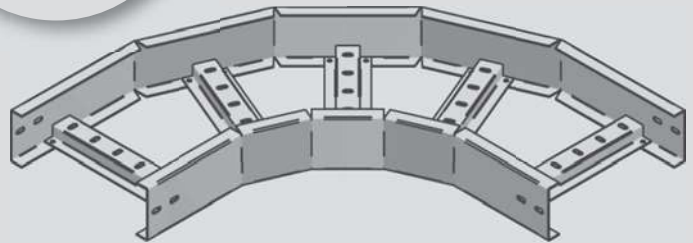

◀ **Edgewise Elbow Left**
SCL/C/I/WD AC-7
SCL/C/I/KD AC-7

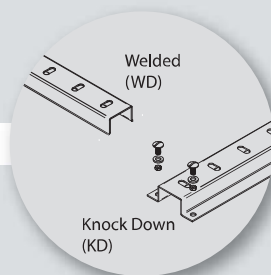

Edgewise Elbow Right ▶
SCL/C/I/WD AC-8
SCL/C/I/KD AC-8

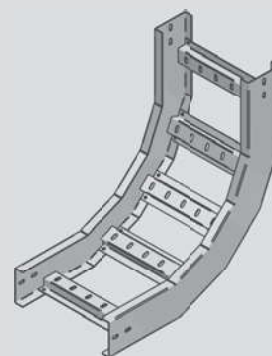

**Other design and sizes are available upon request.

"Type C - Inner" - WD/KD

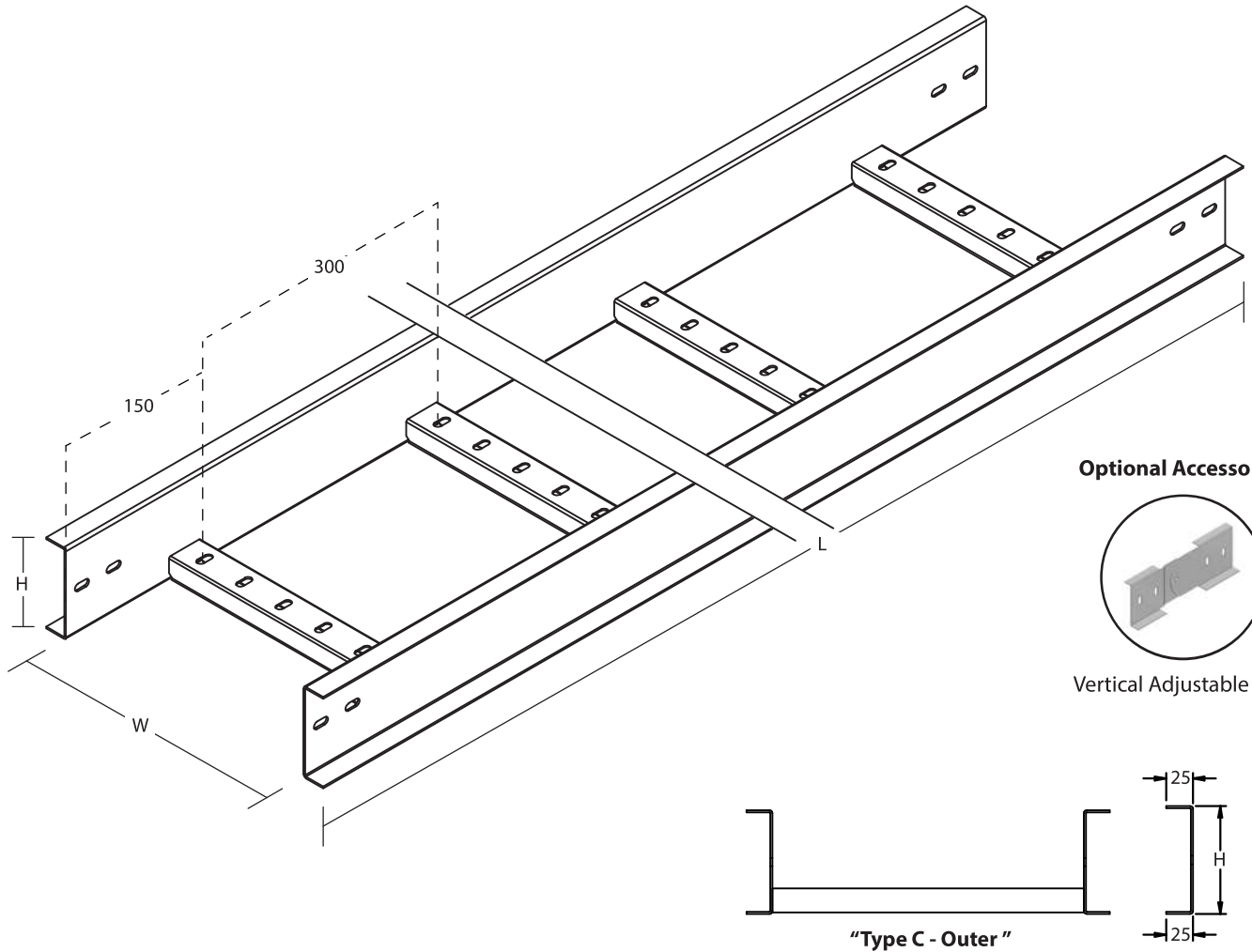

Cable Ladder "Type C - Outer" - Welded (WD)

Model	Nominal Size (mm)		
	Body (LxWxH)	Splice Plate (H)	Thickness
SCL/C/O-(150X50)-WD	2438 / 3000 x 150 x 50	45	2
SCL/C/O-(200X50)-WD	2438 / 3000 x 200 x 50	45	2
SCL/C/O-(250X50)-WD	2438 / 3000 x 250 x 50	45	2
SCL/C/O-(300X50)-WD	2438 / 3000 x 300 x 50	45	2
SCL/C/O-(150X75)-WD	2438 / 3000 x 150 x 75	70	2
SCL/C/O-(200X75)-WD	2438 / 3000 x 200 x 75	70	2
SCL/C/O-(250X75)-WD	2438 / 3000 x 250 x 75	70	2
SCL/C/O-(300X75)-WD	2438 / 3000 x 300 x 75	70	2
SCL/C/O-(450X75)-WD	2438 / 3000 x 450 x 75	70	2
SCL/C/O-(600X75)-WD	2438 / 3000 x 600 x 75	70	2
SCL/C/O-(900X75)-WD	2438 / 3000 x 900 x 75	70	2
SCL/C/O-(150X100)-WD	2438 / 3000 x 150 x 100	95	2
SCL/C/O-(200X100)-WD	2438 / 3000 x 200 x 100	95	2
SCL/C/O-(250X100)-WD	2438 / 3000 x 250 x 100	95	2
SCL/C/O-(300X100)-WD	2438 / 3000 x 300 x 100	95	2
SCL/C/O-(400X100)-WD	2438 / 3000 x 400 x 100	95	2
SCL/C/O-(450X100)-WD	2438 / 3000 x 450 x 100	95	2
SCL/C/O-(500X100)-WD	2438 / 3000 x 500 x 100	95	2
SCL/C/O-(600X100)-WD	2438 / 3000 x 600 x 100	95	2
SCL/C/O-(750X100)-WD	2438 / 3000 x 750 x 100	95	2
SCL/C/O-(900X100)-WD	2438 / 3000 x 900 x 100	95	2

**Specification subject to change without prior notice.
 ***Thickness Tolerance with + - 10%

*For order information, please refer page 63.

Cable Ladder System

Cable Ladder Straight "Type C - Outer" (Welded)

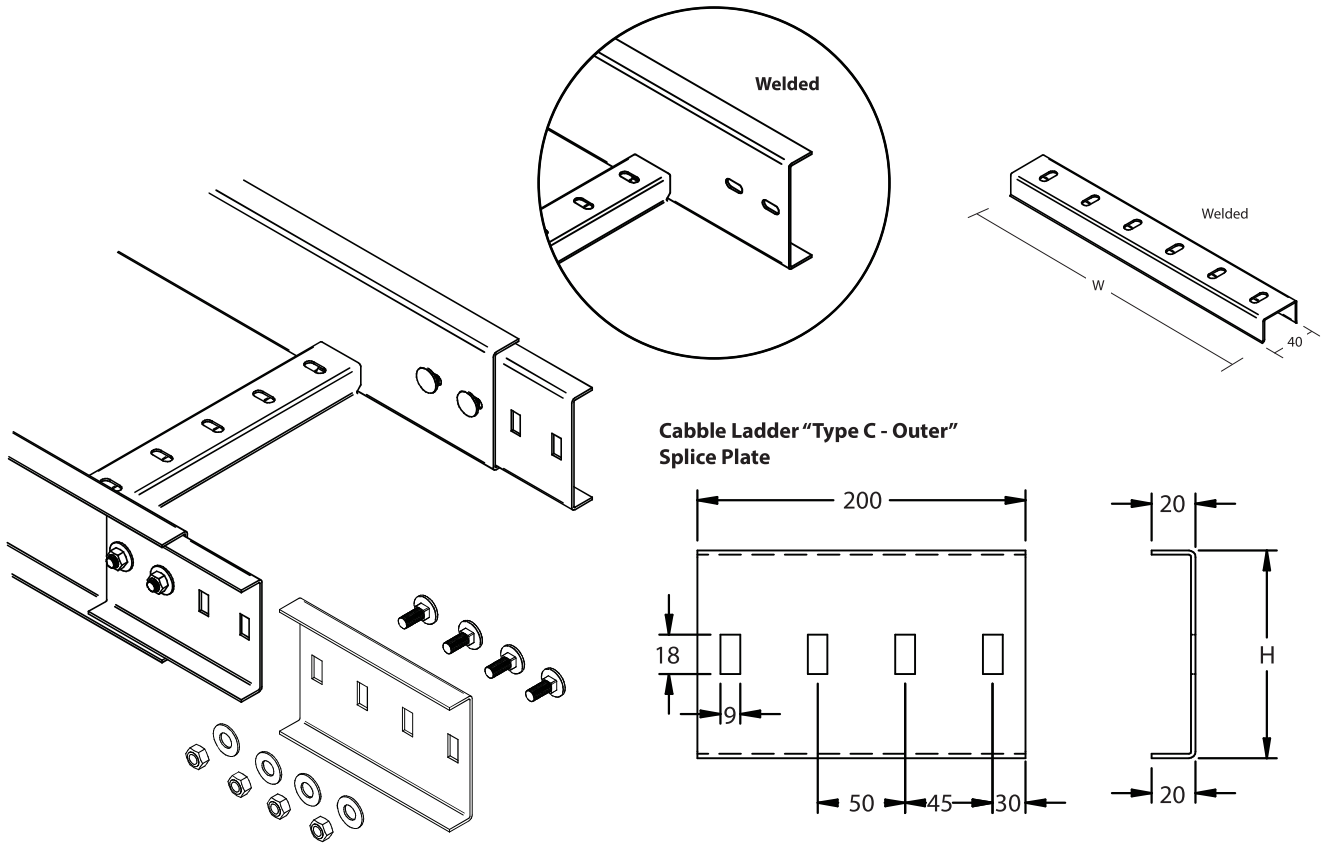

Dimension in Millimeter (mm)

L : Length
W : Width
H : Height

Cable Ladder "Type C - Outer" - Welded (WD)

Model	Nominal Size (mm)		
	Body (LxWxH)	Splice Plate (H)	Thickness
SCL/C/O-(1000X100)-WD	2438 / 3000 x 1000 x 100	95	2
SCL/C/O-(200X125)-WD	2438 / 3000 x 200 x 125	120	2
SCL/C/O-(250X125)-WD	2438 / 3000 x 250 x 125	120	2
SCL/C/O-(300X125)-WD	2438 / 3000 x 300 x 125	120	2
SCL/C/O-(400X125)-WD	2438 / 3000 x 400 x 125	120	2
SCL/C/O-(450X125)-WD	2438 / 3000 x 450 x 125	120	2
SCL/C/O-(500X125)-WD	2438 / 3000 x 500 x 125	120	2
SCL/C/O-(600X125)-WD	2438 / 3000 x 600 x 125	120	2
SCL/C/O-(750X125)-WD	2438 / 3000 x 750 x 125	120	2
SCL/C/O-(900X125)-WD	2438 / 3000 x 900 x 125	120	2
SCL/C/O-(1000X125)-WD	2438 / 3000 x 1000 x 125	120	2
SCL/C/O-(200X150)-WD	2438 / 3000 x 200 x 150	145	2
SCL/C/O-(250X150)-WD	2438 / 3000 x 250 x 150	145	2
SCL/C/O-(300X150)-WD	2438 / 3000 x 300 x 150	145	2
SCL/C/O-(400X150)-WD	2438 / 3000 x 400 x 150	145	2
SCL/C/O-(450X150)-WD	2438 / 3000 x 450 x 150	145	2
SCL/C/O-(500X150)-WD	2438 / 3000 x 500 x 150	145	2
SCL/C/O-(600X150)-WD	2438 / 3000 x 600 x 150	145	2
SCL/C/O-(750X150)-WD	2438 / 3000 x 750 x 150	145	2
SCL/C/O-(900X150)-WD	2438 / 3000 x 900 x 150	145	2
SCL/C/O-(1000X150)-WD	2438 / 3000 x 1000 x 150	145	2

**Specification subject to change without prior notice.
***Thickness Tolerance with + - 10%

*For order information, please refer page 63.

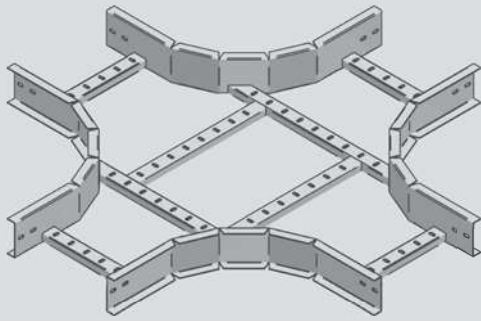

◀ **Flatwise Equal/Unequal Cross**
SCL/C/O/WD AC-1

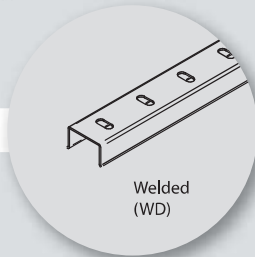

Flatwise Equal/Unequal Tee ▶
SCL/C/O/WD AC-2

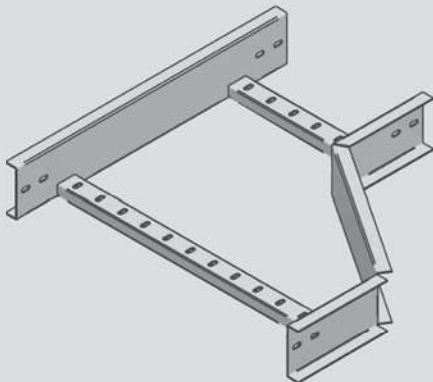
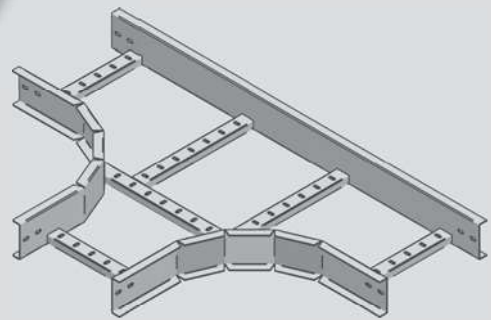

◀ **Righthand Reducer**
SCL/C/O/WD AC-3

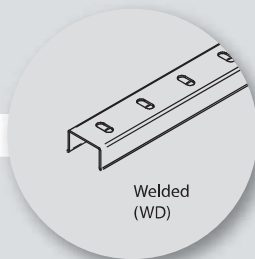

Lefthand Reducer ▶
SCL/C/O/WD AC-4

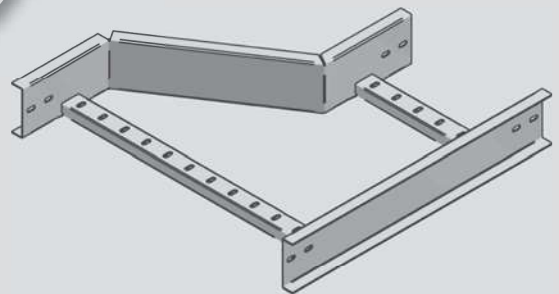

**Other design and sizes are available upon request.

"Type C - Outer" - WD 

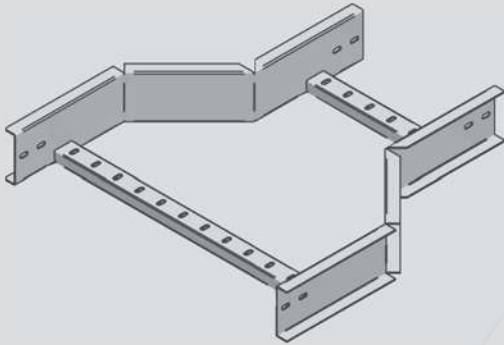

◀ **Straight Reducer**
SCL/C/O/WD AC-5

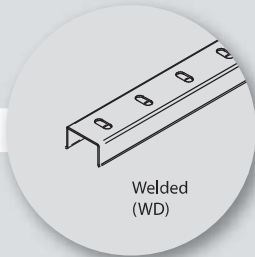

Welded (WD)

Flatwise Elbow ▶
SCL/C/O/WD AC-6

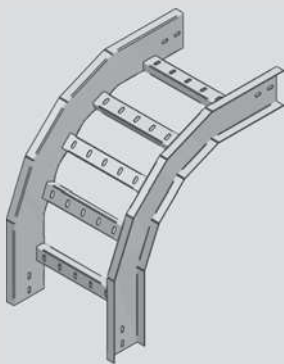
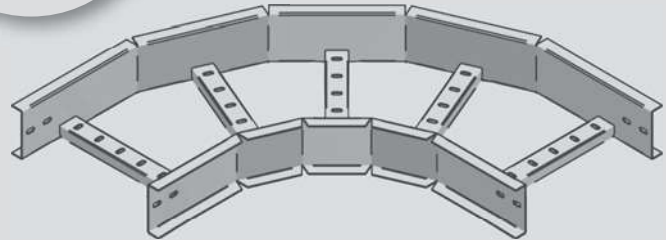

◀ **Edgewise Elbow Left**
SCL/C/O/WD AC-7

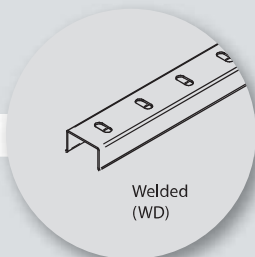

Welded (WD)

Edgewise Elbow Right ▶
SCL/C/O/WD AC-8

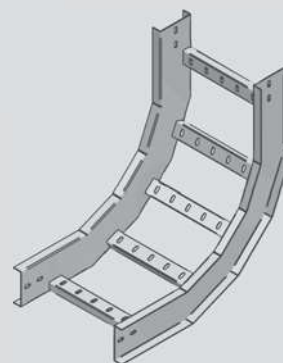

**Other design and sizes are available upon request.

"Type C - Outer" - WD

Product Range	Profile Type	Size	Optional	Thickness	Material/ Finishing	Color Coating
STK (Cable Trunking)	-	Refer Catalogue (Body Straight)	-	Refer Catalogue (Body Straight)	*Refer Below	Orange : O Red : R Green : G Blue : B Beige : E White : W Grey : Y
SCT (Cable Tray)	U (Type U)		-			
	C (Type C)		45D (45°)			
	T (Type T)		90D (90°)			
SCL (Cable Ladder)	Z (Type Z)		-			
	G/I (Type G, Inner)		*WD (Welded)			
			KD (Knock Down)			
	G/O (Type G, Outer)		*WD (Welded)			
			KD (Knock Down)			
	C/I (Type C, Inner)		*WD (Welded)			
KD (Knock Down)						
C/O (Type C, Outer)	*WD (Welded)					

*Material are not applicable for welded only.

Material

Cold Rolled SteelCR
 Hot Rolled SteelHDG
 Electro GalvanisedEG
 Galvanised IronGI
 SuperDymaSD
 PosMacPM
 Stainless SteelSS

Finishing

Epoxy powder Coated
 Hot Dip Galvanised
 Epoxy powder Coated
 Original Finish or with Epoxy Powder Coated
 Original Finish or with Epoxy Powder Coated
 Original Finish or with Epoxy Powder Coated
 Stainless Steel 304 or 316

Example Order: SCL/Z-(550x100)-WD/2.0/GI/O

Model

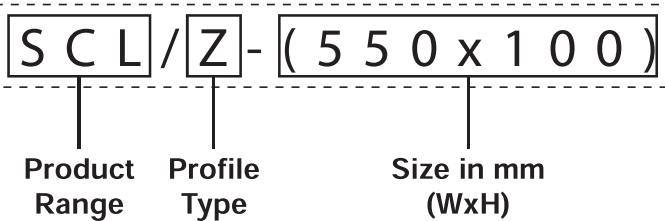

Others

